

Text in blue shows those memorials which have been updated

2018-Jan-25

Monumental Inscriptions

Of

Baptist Church

PONTESBURY Shropshire

1858-1970

Transcribed by Dennis George 1989

Typed by Pat Berry

**SHROPSHIRE FAMILY HISTORY
SOCIETY**

1992

- 1 SARAH THOMAS died 3 December 1909 aged 74; also CHARLES her husband died 16 November 1915 aged 85.
- 2 MARY ANN wife of EDWARD ALBERT GRAY died 10 May 1900 aged 34.
- 3 ROBERT HAYWARD died 24 April 1868 aged 64.
- 4 Rev E TIPTON, eldest son of the late JAMES and MARIA TIPTON, Pontesbury Hill, died 7 February 1919 aged 64. Also MARIA wife of JAMES TIPTON of Pontesbury Hill died 18 March 1870 aged 36. Also MARIA their daughter died 26 January 1858 aged 1 year and 10 months. Also JAMES TIPTON died 11 August 1898 aged 66.
- 5 WILLIAM CHIDLEY of Pontesbury Hill died 2 January 1887 aged 65. Also ELIZABETH his wife died 10 April 1893 aged 62. Also MERCY their daughter died 29 September 1911 aged 56.
- 6 EDWARD ALBERT eldest son of EDWARD and SARAH JANE GRAY of Shrewsbury died 2 June 1893 aged 28 (or 23).
- 7 JOHN HAYWARD died 15 May (no other details visible).
- 8 JOHN THOMAS of Pontesbury Hill died 25 June 1881 aged 67. Also HANNAH his wife died 18 November 1895 aged 76.
- 9 ELLA BESSIE LOWE nee LAKELIN died 24 May 1942 aged 27.
- 10 WALTER BETTON LAKELIN, Mount Nursery, Pontesbury died 6 August 1946 aged 65. Also KATE his wife died 18 November 1962 aged 84.
- 11 MARY wife of W HOLYOAKE died 27 March 1898 aged 61; also EMMA wife of JOSIAH EDWARDS and daughter of the above died 19 January 1884 aged 24; also WILLIAM HOLYOAKE husband of MARY above died 6 August 1912 aged 77.
- 12 ELIZABETH HAYWARD died 1 July 1900 aged 50; also JOHN her son died 6 May 1905 aged 30.
- 13 WILLIAM TOMLINS of Pontesbury died 2 October 1871 aged 66; also RUTH his wife died 26 May 1874 aged 56.
- 14 JOSEPH SMITH of Pontesbury died 21 November 1869 aged 41; also ELIZABETH OLWEN wife of Rev JOSEPH SMITH died 7 August 1869 aged 50.

- 15 JOSEPH LAKELIN, Baptist Minister died 3 October 1858 aged 84; also SARAH ANNIE JONES bom 24 November 1862 died 27 January 1976. Also ANN wife of JOSEPH LAKELIN of Pontesbury died 13 June 1871 aged 59; also JOSEPH LAKELIN died 27 June 1885 aged 77.
- 16 ALFRED LAKELIN died 4 May 1922 aged 48; also CATHERINE his wife died 29 September 1953 aged 75.
- 17 Rev THOMAS EVANS bom Narberth 29 March 1839, entered Haverfordwest Baptist College 1 July 1858, was pastor Baptist Chapel, Waterford from 1861 to 1864. Pastor Pontesbury Baptist Church 1866 to 1904, died 10 June 1913.
- 18 MARY JANE wife of EBANEZER GRIFFITHS, bom at Sommerton Pembrokeshire, died at Brook Gate Plealey 12 February 1936 aged 75.
- 19 RUTH TURNER died 8 September 1945 aged 93.
- 20 EDITH MARY only daughter of MOSES PRICE and MARY JANE JONES of Pontesbury died 1 July 1877 aged 2; also JAMES RODERICK their eldest son and husband of LILLIE JONES died 6 November 1917 aged 44 and was buried in the Military Cemetery at Heerseba; also AMY ELEANOR JONES their daughter died 6 August 1932 aged 48; also MARY ANN JONES died 23 November 1936 aged 86; MOSES PRICE JONES her husband died 6 December 1945 aged 97; also ETHEL MARY JONES died at Truro 14 February 1970 aged 91
- 21 ELLA wife of WILLIAM HIGLEY died 13 January 1915 aged 38; also VERA HIGLEY died 30 December 1970 aged 68.
- 22 ELIZABETH LAKELIN bom 2 March 1841 died 10 January 1916; also THOMAS LAKELIN died 28 September 1882 aged 44; also JOHN and JANET their Infant children.
- 23 EDTH MARY JONES died 3 July 1937 aged 69; also WILLIAM her husband died 30 May 1940 aged 73. 24 BETSY wife of THOMAS ROBERTS of Minsterley died 25 March 1887 aged 36; also ELSIE MARY died 21 March 1887 aged 6 months; also BESSIE died 17 January 1895 aged 12; also RHOMAS ROBERTS of Minsterley, bom 23 May 1849 died 15 September 1927; also MARY JANE ROBERTS of Minsterley bom 2 February 1842 died 9 April 1936. 25 JANE ROBERTS of Horsebridge died 1 September 1905 aged 75.
- 26 MOSES SAMUEL McEWEN, Inland Revenue Officer, Pontesbury died 3 October 1893 aged 55.

- 27 JANE CLAYTON died 22 February 1919 aged 91; also DAVID CLAYTON died 22 February 1883 aged 91; also HELEN CLAYTON died 16 March 1939 aged 76; also ELIZA ROBERTS died 6 January 1917. 28 THOMAS HENRY LAKELIN died 9 April 1946 aged 74; also ELIZABETH ANN his wife died 25 May 1955 aged 83.
- 29 EDITH JANE COLE (sister) nee BEADY, Pontesbury died 15 November 1918 aged 43.
- 30 GEORGE, youngest son of WILLIAM and ELIZABETH WILLIAMS of Pontesbury, died at Dorrington station 7 October 1895 aged 33; also WILLIAM WILLIAMS, Holly Grove, Pontesbury died 23 November 1902; also ELIZABETH his wife died 22 February 1905 (no ages given).
- 31 EMMA WILLIAMS died 29 August 1916 aged 66; also THOMAS her husband died 12 October 1918 aged 73.
- 32 JANE MORGAN BEADY, mother, Pontesbury died 14 January 1915 aged 70.
- 33 WILLIAM uncle to GEORGE BEADY, died 10 November 1868 aged 81; also TRYPHENA PRANCES wife to GEORGE BEADY died 19 September 1867 aged 49; also GEORGE MORGAN BEADY died 29 December 1886 aged 76.
- 34 MARY widow of HERBERT JOHN BADDELEY died 2 July 1882 aged 76.
- 35 JAMES WRIGHT died 28 January 1920 aged 83; also DINAH his wife died 17 February 1927 aged 81.

MONUMENTAL INSCRIPTIONS INDEX

BADDELEY	34	JONES	15, 20, 23
BEADY	29, 32, 33	IAKELIN	9, 10, 15 16, 22, 28
BETTON	10*	LOWE	9
CHIDLEY	5	McEWEN	26 P
CLAYTON	27	RICE	20*
COLES	29	ROBERTS	24, 25, 27
EDWARDS	11	SMITH	14
EVANS	17	THOMAS	1, 8
GRAY	29, 6	TIPTON	4
GRIFFITHS	18	TOMLINS	13
HAYWARD	3, 7, 12	TURNER	19
HIGLEY	21	WILLIAMS	30, 31
HOLYOAXE	11	WRIGHT	35

Numbers marked * are first names which may indicate a mother's maiden name.

Monumental Inscriptions

at

**Congregational Church
PONTESBURY**

Shropshire

Transcribed by Church Members

**Roger Jones
Denis George
1980-1990**

Typed in machine readable form by

**Michael J Hulme
2000**

**SHROPSHIRE FAMILY HISTORY
SOCIETY
1991**

Monumental Inscriptions at Congregational Church. PONTESBURY. Shropshire 1844-1990

INTRODUCTION

The Congregational Church, Pontesbury, Shropshire was opened on Christmas day 1839.

This transcript of the monumental inscriptions has been compiled from several sources which are listed below.

Researchers should note that the various sources do not agree in several respects, and that where a discrepancy is found other records should be checked to determine the correctness of the information contained in this transcript.

Items a) and b) below have been provided by the Minister, Rev. Richard Cleaves MA PhD, to whom we are very grateful for his help and co-operation in the making of this transcript.

Component Parts:

- a A typescript of the gravestone readings made during the early 1980s by members of the Church. The details from this list were the first to be entered into the present transcript and provided the numbers from (1) to (100) which will be found down the left hand margin.
- b A plan of the larger part of the Churchyard (the area to the right of the path leading to the Church) together with a chart listing the burials (most entries are very brief). This appears to have been kept up to date until the late 1940s. This only covers the larger part of the Churchyard, but uses the same numbering sequence as a) above.
- c Around 1981/2 fourteen stones in the smaller part of the Churchyard (those to the left of the path leading to the Church) were recorded by Roger Jones before the Churchyard was cleared, and are shown in the present transcript by the heading 'JONES Transcript'.
- d In 1990 all the stones then surviving in the Churchyard were recorded by Denis George. At this date there were only forty nine stones in the Churchyard (a number were removed in the early 1980s) and a further eight inside the Church which have not been recorded previously. This recording is shown after the heading '1990 Transcript'. Where there is a difference in the details shown from the various sources, this is likely to be the most reliable because the recorder has had the advantage of being able to check the actual gravestones.
- e A photocopy of one page from the burial register covering the years 1883 to 1888 is attached for information. The original registers are still with the Church in January 1991.

Graves numbered 1 to 23 are situated on the narrow left side of the churchyard and graves 24 to 100 are on the larger right side of the churchyard.

1 No record.

2 William son of John and Anne DAVIES died 27 Apr 1861 aged 3 years.

JONES Transcript William son of John and Ann DAVIES died 27 Apr 1861 aged 3 years.

3 Ruth Bedward OWEN died 3 June 1890 aged 1 year.

Also Martha Elizabeth OWEN died 16 Oct 1890 aged 19 years.

Also Edith Mary OWEN died 26 Dec 1893 aged 21 years.

Also two infant daughters of Richard and Elizabeth OWEN died 1855 and 1858. 1990 Transcript [Broken stone] Bedward OWEN died 3 Jun 1890 aged 1 year.

Also Martha Elizabeth OWEN died 16 Oct 1890 aged 19.

Also Edith Mary OWEN died 26 Dec 1893 aged 21.

Also two infant daughters of Richard and Elizabeth OWEN of Hinton who died in 1855 and 1858.

4 No record.

5 Henry son of Humphrey and Elizabeth LITTLEHALES died 12 Jun [year not given] aged 20 years.

Also Jon their son died 26 Dec 1846 aged 21 years.

Also mother Elizabeth died 4 Mar 1847 aged 54 years.

Also Humphrey LITTLEHALES died 12 May 1855 aged 81 years.

JONES Transcript Henry, son of Humphrey and Elizabeth LITTLEHALES 12 Jun 1841 aged 20 years.

Also John son of Humphrey and Elizabeth LITTLEHALES died 26 Dec 1846 aged 21 years.

Also Elizabeth LITTLEHALES died 4 March 1847 aged 45 years.

Also Humphrey LITTLEHALES died 12 May 1855 aged 81 (or 84?).

1990 Transcript Henry son of Humphrey and Elizabeth LITTLEHALES died 12 Jun 1844 aged 20.

Also John their son died 26 Dec 1846 aged 21.

Also Elizabeth their mother died 4 Mar 1847 aged 54.

Also Humphrey LITTLEHALES died 12 May 1855 aged 84.

6 William Reeve CROFT died 3 Oct 1904 aged 66 years.

Also Mary CROFT died 4 Jun 1886 aged 42 years.

Also Jessie YELLAND died 3 May 1882 aged 31 years.

JONES Transcript William Reeve CROFT died 3 Oct 1904 (or 1914?) aged 66. Mary CROFT died 13 Jun 1886 aged 42. Jessie YETLAND died 3 May 1882 aged 31 years.

7 No record

8 No record

9 No record

10 No record

11 John DAVIES died 1 Sep 1907.
Also Anne died 16 Dec 1910.

JONES Transcript John DAVIES of Pontesford 1 Sep 1907 aged 78 years.

Also Anne his wife died 16 Dec 1910 aged 7[?].

1990 Transcript John DAVIES of Pontesford died [?] Sep 1907 aged 78.
Also Anne his wife [] 1910 [].

12 Anne wife of Charles Edward CROFT, Wood Farm, Minsterley died 30 Dec 1903 aged 36 years.

Also Charles Edward CROFT died 15 Sep 1947 aged 83 years.

JONES Transcript Edith, wife of Charles Edward CROFT, Wood Farm, Minsterley, died 3 Dec 1903 aged 36 years.

Also Charles Edward CROFT died 15 Sep 1947 aged 83.

1990 Transcript Edith wife of Charles Edward CROFT, Wood Farm, Minsterley, died 30 Dec 1903 aged 36.

Also Charles Edward CROFT died 15 Sep 1947 aged 83.

13 Sarah Anne JONES daughter of Richard and Mary JONES

JONES Transcript Sarah Anne daughter of Rich, and Mary Ann JONES, 22 Apr 1856.

14 John EVANS died 9 Nov.

Also 4 infants.

JONES Transcript John EVANS.

1990 Transcript John EVANS died 9 Nov [??] aged [?].

15 Janet wife of John OWEN died 7 Aug 1874 aged 35 years.

Also John OWEN died 29 Mar 1877 aged 45 years.

Also James Menzies son of John and Janet OWEN died 24 Jul 1873 6 yrs 1 month.

JONES Transcript James Menzies son of John and Janet OWEN, The Villa, Pontesbury died 17 July 1873 aged 6 years 11 months. Janet OWEN died 7 Aug 1874 aged 35. John OWEN, fell from a carriage and killed at Madeley 29 Mar 1877 aged 45 leaving seven orphan children to mourn his loss.

1990 Transcript Janet wife of John OWEN of The Villa, Pontesbury died 7 Aug 1874 aged 35.

Also John OWEN of The Villa, Pontesbury who met with his death by a fall from a carriage at Madeley 29 Mar 1877 aged 45 leaving seven orphan children.

Also James Menzies son of John and Janet OWEN of The Villa, Pontesbury died 17 Jul 1873 aged 6 years and 11 months.

16 No record

17 Harriet daughter of Thomas and Eliza JONES died 24 Jun 1845 aged 19 years.

Also Robert, son, died 26 Aug 1848 aged 17 years.

JONES Transcript Harriet, daughter of Thos. and Eliz. JONES died 24 Jun 1845 aged 19.

Also their son died 26 Aug 1848 aged 17. Robert JONES.

1990 Transcript Harriot daughter of Thos. and Elizth. JONES of Pontesford, died 24 Jun 1845 aged 19.

Also Robert their son, died 26 Aug 1848 aged 17.

18 No record.

19 Anne, wife of Charles CROFT of Farley, died 9 Apr 1874 aged 44 years.

Also Hellen Jessey their daughter died 2 Nov 1872 aged 2 weeks.

Also Mary, second wife died 2 Feb 1888 aged 64 years.

JONES Transcript Anne, wife of Charles CROFT died 9 Apr 1874 aged 44. Helen Jessey daughter died 2 Nov 1872 aged 2 weeks.

Also Mary, second wife of Charles CROFT died 2 Feb 1889 aged 67 years.

1990 Transcript Ann CROFT wife of Charles of Farley, died 9 Apr 1874 aged 44.

Also Hellen Jessey their daughter died 2 Nov 1872 aged 2 weeks.

Also Mary his second wife died 2 Feb 188? [Age not discernable]

20 John, son of Thomas and Elizabeth JONES of Pontesbury died 20 Aug 1861.

Also 3 infants.

JONES Transcript John, son of Thos and Eliz JONES of Pontesford died 10 Aug 1851 age [?].

1990 Transcript John son of Thomas and Eliz... JONES of Pont.... died 20 Aug 18(61?) aged (51?).

Also three children who died in infancy.

21 Harriet and Robert JONES.

22 John Ernest, infant of William and Mary BOUSTRED died 17 Aug 1871 aged 13 years.

Also George Frederick died 20 Dec 1876 aged 6 months.

JONES Transcript John Ernest, son of William and Martha BODSTRED died 17 Aug 1871 aged 13 weeks. Geo Frederick 20 Dec 1876 aged 6 months.

1990 Transcript John Ernest died 17 Aug 1871 aged 13 months, son of William and Martha BOUSTRED.

Also George Frederick died 20 Dec 1876 aged 6 months.

23 Mary CROFT died 17 Jul 1862 aged 78 years.

Also Richard CROFT of Pontesford died 30 May 1877 aged 78 years.

Also Jonah Reeve, son, died 4 Aug 1869 aged 34 years.

JONES Transcript Mary wife of Richard CROFT died 17 Jul 1862 aged 60. Jonah Reeve, son, died 4 Aug 1869 aged 34 years. 1869 Richard CROFT of Pontesford 30 May 1877 aged 38.

1990 Transcript Richard CROFT of Pontesford died 30 May 1877 aged 78.

Also Mary his wife died 17 Jul 1862 aged 68.

Also Jonah Reeve their son died 4 Aug 1869 aged 34.

24 DAVIES (Miss)

25 Grandchild of J. NICHOLAS.

26 Miriam Frances, daughter of John and Miriam DRAYTON died 9 Mar 1878 aged 23 years.

Also Miriam wife of John DRAYTON of Pontesbury died 4 Aug 1885 aged 61 years.

Also John DRAYTON died 24 Jun 1900 aged 79 years.

1990 Transcript Miriam Francis, daughter of John and Miriam DRAYTON of Pontesbury died 9 Mar 1878 aged 23.

Also Miriam wife of John DRAYTON died 4 Aug 1885 aged 61.

Also John DRAYTON above died 24 Jun 1900 aged 79. 27 No record.

28 ? OWEN.

29 No record.

30 Martha BREEZE died 29 Aug 1895 aged 55 years.

Also William her husband died 19 Feb 1914 aged 73 years.

31 Sister of W. DAVIES.

32 Sister of W. DAVIES. 33 Child.

34 Martha wife of William BOUSTREL died 22 Feb 1890 aged 64 years.

Also Lilian Eva their daughter died 24 Feb 1890 aged 16 years.

Also William BOUSTREL, husband died at Johannesburg, SA., Jul 1899. [No day given]

1990 Transcript Martha wife of William BOUSTRED died 22 Feb 1890 aged 54.

Also Lilian Eva their daughter died 24 Feb 1890 aged 16.

Also William BOUSTRED above died at Johannesburg, SA., Jul 1899. [No day given]

- 35 Elizabeth EVANS, of Villa Cottage, Pontesbury, died 6 Feb 1889 aged 69 years.
1990 Transcript Elizabeth EVANS, Villa Cottage, Pontesbury, died 5 Feb 1889 aged 69.
- 36 Sarah Ann daughter of Charles CROFT, Wood Farm, Minsterley, died 30 Aug 1888 aged 30 years.
1990 Transcript Sarah Ann daughter of Charles CROFT, Wood Farm, Minsterley, died 30 Aug 1888 aged 30.
- 37 No record.
- 38 Elizabeth, wife of Richard DA VIES, Willow House, Pontesbury, born 12 Jun 1829, died 6 Jun 1886.
Also Richard DAVIES born 12 Apr 1816, died 3 Jul 1902.
1990 Transcript Elizabeth, wife of Richard DAVIES, Willow House, Pontesbury, born 12 Jun 1829, died 6 Jun 1886.
Also Richard DAVIES born 12 Apr 1816, died 3 Jul 1902.
- 39 Richard DAVIES of Pontesford died 16 Dec 1885 aged 58 years. 1990 Transcript Richard DAVIES of Pontesford died 6 Dec 1885 aged 58.
- 40 John ASTON of Pontesford died 14 Dec 1906 aged 75 years.
Also Mary Ann DAVIES his daughter died 23 Jun 1885 aged 26 years. 1990 Transcript John ASTON, Pontesford, died 14 Oct 1906 aged 75.
Also Mary Ann DAVIES his daughter died 23 Jun 1885 aged 26.
Also William her son died 16 Jan 1886 aged 10 months.
- 41 ASTON.
- 42 Ebenezer CROFT.
- 43 Three sons of JONES (Wharf) namely Thomas died 18 Mar 1903 aged 31 years, Samuel died 30 Mar 1912 aged 31 years, interred at Birkenhead, and Robert died 9 Jan 1911 aged 12 years.
- 44 John ROGERS and wife.
- 45 No record.
- 46 Martha EVANS of Villa Cottage, Pontesbury died 13 Nov 1890 aged 76 years. 1990 Transcript Martha EVANS of Villa Cottage, Pontesbury died 13 Nov 1890 aged 76.
- 47 Mary, wife of George YOUNG of Pontesbury died 13 Feb 1891 aged 71 years.
Also George YOUNG died 13 Nov 1920 aged 88 years

1990 Transcript Mary, wife of George YOUNG of Pontesbury died 13 Feb 1891 aged 71.

Also George YOUNG died 13 Nov 1920 aged 88

48 Father of W. DAVES.

49 Mother of W. DAVES.

50 William DAVES of Lower Mill, Pontesford died 1 Jan 1898 aged 47 years.
Also Abigail his wife died 11 Apr 1932 aged 77 years.

1990 Transcript William DAVES of Lower Mill, Pontesford died 1 Jan 1899 aged 47.

Also Abigail his wife died 11 Apr 1932 aged 77.

51 Sarah HUMPHREYS died 16 Dec 1898 aged 68 years.

Also Thomas her husband died 1 Dec 1904 aged 70 years.

Also John George (Jonnie) their grandson, and son of John and Edith HUMPHREYS, of Pontesford, died 22 Feb 1918 in Palestine.

1990 Transcript Sarah HUMPHREYS died 16 Dec 1899 aged 61.

Also Thomas her husband died 1 Sep 1904 aged 70.

Also John George (Jonnie) only son of John and Edith HUMPHREYS, of Pontesford, and grandson of the above died 22 Feb 1919 in Palestine aged 26.

52 Edward HUMPHREYS of Hinwood died 22 Dec 1905 aged 63 years.

Also Ann his wife died 11 Feb 1916 aged 75 years.

1990 Transcript Edward HUMPHREYS of Hinwood died 22 Dec 1905 aged 63.

Also Ann his wife died 11 Feb 1916 aged 75.

53 Harriet GOUGH of Pontesford died 22 Jun 1894 aged 79 years.

Also Isaac GOUGH.

54 No record.

55 No record.

56 EDWARDS Mrs.

57 EDWARDS.

58 Charles CROFT.

59 Rev. Walter PRICE, 45 years Minister Congregational Churches of Minsterley and Pontesbury, died 17 Feb 1929 aged 94 years.

Also Mary his wife died 2 Mar 1916 aged 87 years.

1990 Transcript Mary wife of Rev. Walter PRICE, Minister, died 2 Mar 1916 aged 87.

Also Rev. Walter PRICE, 45 years Minister of the Congregational Churches at Minsterley and Pontesbury, died 17 Feb 1929 aged 94.

- 60 William JONES of Pontesbury died 5 Nov 1907 aged 74 years.
Also Jane his widow died 16 Jul 1919 aged 71 years.
- 61 Sarah EVANS of Boycott died 7 Sep 1908 aged 65 years.
Also Robert her husband died 4 Aug 1914 aged 78 years.
1990 Transcript Sarah EVANS (of Boycott) died 7 Sep 1908 aged 65.
Also Robert her husband died 4 Aug 1914 aged 78.
- 62 Mary Elian (Nellie) daughter of George and Lavinia WALKER of Pontesford
born 11 Jun 1890 died 9 Jun 1910. George husband died 9 Sep 1918 aged
76 years.
Also Lavinia wife died 22 Dec 1922 aged 81 years.
1990 Transcript Mary Ellen (Nellie) daughter of George and Lavinia
WALKER of Pontesford born 11 Jun 1880 died 9 Jun 1910.
Also George WALKER of Pontesford died 9 Sep 1918 aged 76.
Also Lavinia his wife died 22 Dec 1922 aged 81.
- 63 Martha YELLAND died 24 Jun 1914.
- 64 No record.
- 65 M. WALKER and W. WALKER.
- 66 W. GRIFFITHS and wife.
- 67 Mrs SHEEN daughter of No.51 or No.52.
- 68 Charles eldest son of Samuel and Emily ASTON died 5 Apr 1914 aged 23
years.
1990 Transcript Charles eldest son of Samuel and Emily ASTON died 5
Apr 1914 aged 23.
- 69 Samuel ASTON of Pontesbury died 17 Feb 1929 aged 67 years.
Also Emily ASTON died 11 May 1937 aged 68 years.
- 70 JONES (Nills) child.
- 71 Catherine Elinor JONES (Nills) died 20 Jan 1937 aged 68 years.
Also husband David died 27 Mar 1942 aged 77 years.
Also Catherine Elizabeth MORGAN died 13 Mar 1983 aged 89 years.
Also Edwin MORGAN died 9 Feb 1937 aged 47 years.
1990 Transcript Catherine Elinor JONES died 20 Jan 1937 aged 68.
Also David her husband died 27 Mar 1942 aged 77.
Also Edwin MORGAN died 9 Feb 1937 aged 47.
Also Catherine Elizabeth MORGAN died 13 Mar 1983 aged 89.
- 72 Annie HUMPHREYS died 30 Dec 1934 aged 67 years.
1990 Transcript Minnie HUMPHREYS died 30 Dec 1934 aged 67.

- 73 Marie Annie wife of the late John Charles CROWE of Manchester, youngest daughter of the late John DRAYTON of Pontesbury, died 20 Dec 1962 aged 58 years.
Also Mildred Miriam her eldest daughter died 21 Jul 1935 aged 48 years.
1990 Transcript Mary Annie wife of the late John Charles CROWE of Manchester, and youngest daughter of John DRAYTON of Pontesbury, died 20 Dec 1922 aged 58.
Also Mildred Miriam her eldest daughter died 21 Jul 1935 aged 48.
- 74 Capt. W. OLDFIELD, West View, Minsterley, died 7 Feb 1928. [No age given] 1990 Transcript Capt. W. OLDFIELD, West Villa, Minsterley, died 7 Feb 1928. Husband. [No age given]
- 75 Helen CROFT, child.
- 76 John HUMPHREYS, Pontesbury died 4 Nov 1927 aged 66 years.
Also Edith his wife died 12 Jan 1936 aged 72 years.
- 77 Anne widow of James PREECE, Marton, died 10 Feb 1922 aged 83 years.
1990 Transcript Ann PREECE, widow of the late John PREECE, Marton, died 10 Feb 1922 aged 83.
- 78 Two daughters of Sam EVANS.
- 79 Richard EVANS.
- 80 Sam EVANS and wife.
- 81 John Davies JONES died at The Manse, Hadnall, 24 Apr 1928 aged 65 years, after 37 years Pastor at Minsterley and Pontesbury 1906-1925.
Also Mary his wife died 26 Jul 1951 aged 80 years.
1990 Transcript John Davies JONES died at The Manse, Hadnall, 24 Apr 1928 aged 65, after 37 years service in the Congregational Ministry. Pastor of Minsterley and Pontesbury 1906-1925.
Also Mary his wife died 26 Jul 1951 aged 80.
- 82 Walter Arthur son of Walter and Lilian DAVIES died 6 Feb 1919 aged 10 months.
1990 Transcript Walter Arthur dear Sonnia infant of Walter and Lilian DAVIES died 6 Feb 1919 aged 10 months. [Copied as found on stone]
- 83 New grave.
- 84 William Oswald PARRY died 22 Mar 1970 aged 86 years.
1990 Transcript William Oswald PARRY died 22 Mar 1970 aged 86.
Also Elizabeth his wife died 21 Jun 1990 aged 99.

- 85 WILLIAMS Jemima, late of Kimberley, SA., born 16 Jul 1906, died 17 Apr 1965. 1990 Transcript Jemima WILLIAMS late of Kimberley, born 16 Jul 1906 died 17 Apr 1965.
- 86 Amy Nora, wife of Thomas JONES, Glenora, Linley Av., died 1 Mar 1962 aged 83 years.
Also Thomas her husband died 17 Sep 1968 aged 90 years.
1990 Transcript Amy Nora JONES, "Elenora", Linley Avenue, died 1 Mar 1962 aged 83.
Also Thomas her husband died 17 Sep 1968 aged 90.
- 87 Gwendoline Cordelia JONES died 22 Jul 1942 aged 32 years.
Also Katherine Annie died 23 Dec 1975 aged 60 years.
Also Joseph Evan JONES died 7 Apr 1976 aged 63 years.
1990 Transcript Gwendoline Cordelia JONES died 22 Jul 1942 aged 32.
Also Katherine Annie died 23 Dec 1975 aged 60.
Also Joseph Evan JONES died 7 Apr 1976 aged 63.
- 88 Susanna Catherine CROFT died 1 May 1951 aged 72 years.
Also William CROFT died 28 Jan 1962 aged 85 years.
Also daughter Helen Jessie died 16 Oct 1924 aged 4 years.
1990 Transcript Susannah Catherine CROFT died 1 May 1951 aged 72.
Also William CROFT died 28 Jan 1962 aged 85.
Also Helen Jessie their daughter died 16 Oct 1924 aged 4.
- 89 Mrs JONES (Farley Grange).
- 90 No record.
- 91 No record.
- 92 No record.
- 93 Jane Elizabeth EVANS born 23 Jun 1881 died 10 Sep 1955.
Also John Thomas EVANS her husband born 11 Apr 1881, died 22 Sep 1960.
1990 Transcript Jane Elizabeth EVANS born 23 Jun 1881 died 10 Sep 1955.
Also John Thomas EVANS her husband born 11 Apr 1881 died 22 Sep 1960.
Also Robin Richard EVANS died 12 Dec 1985 aged 22.
- 94 John NICHOLAS died 3 May 1940 aged 93 years.
Also Ellen his wife died 1 Dec 1947 aged 94 years.
1990 Transcript John NICHOLAS died 3 May 1940 aged 93.
Also Ellen his wife died 1 Dec 1947 aged 94.

- 95 Pryce DAVIES of Stoke Manor died 7 Jun 1952 aged 74 years.
Also Emma his wife died 14 Feb 1960 aged 81 years. 1990 Transcript Pryce DAVIES of Stoke Manor died 7 Jun 1952 aged 74.
Also Emma his wife died 14 Feb 1960 aged 81. 96 No record.
- 97 Joseph John BETTON died 3 Feb 1944 aged 60 years.
Also Sarah Ethel his wife died 18 Jan 1960 aged 78 years.
1990 Transcript Joseph John BETTON died 3 Feb 1944 aged 60.
Also Sarah Ethel his wife died 18 Jan 1960 aged 78. 98 No record.
- 99 Harold Herbert BENNETT, South View, Pontesbury died 15 Apr 1940 aged 37 years. 1990 Transcript Harold Herbert BENNETT, South View, Pontesbury died 15 Apr 1940 aged 37.
- 100 Edith BENNETT, Woodfield, Pontesbury died 12 May 1942 aged 76 years.
Edwin BENNETT died 8 Oct 1952 aged 81 years.
1990 Transcript Edith BENNETT, Woodfield, Pontesbury died 12 May 1942 aged 76.
Also Edwin BENNETT died 8 Oct 1952 aged 81.

Inside church clockwise from door

All the entries from the inside of the Church were recorded during 1990.

- Ch. 1 Marble tablet. Richard CROFT of Pontesbury, a Deacon of this Church for 37 years died 30 May 1877 aged 78. Also Mary his wife died 17 Jul 1862 aged 68. This tablet erected by their children.
- Ch.2 Bronze plate on reading desk. In memory of Mary DAVIES, William and Martha DAVIES, Martha DAVIES, Mercy and Francis FRANCE. The gift of Mary M. COTTON and W.J. DAVIES. 1839-1939.
- Ch.3 Brass plate on lectern. In memory of Edith and Edward BENNETT. Presented by their daughter Clara Edith OLIVER 28 Jun 1967.
- Ch.4 Marble tablet. John George (Johnnie) only son of John and Edith HUMPHREYS, Rose Cottage, Pontesford died 22 Feb 1919 in the military hospital Deir El Belah, Palastine aged 25. Erected by his parents.
- Ch.5 Brass plate. Rev. Hywel Emlyn HOWELL Ministered in this Church 1950-1980.
- Ch.6 Brass plate on umbrella stand. Gift of the Sunday School Centenary 1939.
- Ch.7 Bronze plate. This porch was erected by the family of William Reeve CROFT and Mary CROFT, Maria YELL AND, Jessie Ethelwyn CROFT and Helen Jessie CROFT. May 1939.
- Ch.8 Metal plate in back hall. This hall was opened on 22 Jul 1971 by W.E. BENNETT, Esq. J.P., to honour his loyalty and service to the Church as secretary for 50 years, 1919-1969.

Index

ASTON	?	41	DAVIES	John	11
ASTON	Charles	68	DAVES	Martha	Ch.2
ASTON	John	40	DAVES	Mary Ann.	40
ASTON	Samuel	69	DAVES	Mary	Ch.2
BENNETT	Edith.	100, Ch.3	DAVES	Miss	24
BENNETT	Edward	Ch.3	DAVES	Mother of W.	49
BENNETT	Edwin	100	DAVES	Prvce	95
BENNETT	Harold Herbert	99	DAVES	Richard	38,39
BENNETT	W.E.	Ch.4	DAVES	Sister of W	31, 32
BETTON	Joseph John.	97	DAVES	W.J.	Ch.2
BETTON	Sarah Ethel	97	DAVES	Walter Arthur.	82
BOUSTRED	George Frederick	22	DAVES	William . .2, 40, 50, Ch.2	
BOUSTRED	John Ernest	22	DRAYTON	John Charles	73
BOUSTREL	Lilian Eva.	34	DRAYTON	John	26
BOUSTREL	Martha	34	DRAYTON	Miriam Frances.	26
BOUSTREL	William	34	DRAYTON	26	
BREEZE	Martha	30	EDWARDS	?	57
BREEZE	William	30	EDWARDS	Mrs.	56
COTTON	Mary M	Ch.2	EVANS	Elizabeth	35
CROFT	Anne.	12, 19	EVANS	Jane Elizabeth	93
CROFT	Charles Edward	12	EVANS	John Thomas	93
CROFT	Charles	58	EVANS	John	14
CROFT	Ebenezer.	42	EVANS	Martha	46
CROFT	Edith.	12	EVANS	Richard	79
CROFT	Helen Jessie.	88, Ch.4	EVANS	Robert.	61
CROFT	Helen	75	EVANS	Robin Richard.	93
CROFT	Hellen Jessey	19	EVANS	Sam	80
CROFT	Jessie Ethelwyn	Ch.4	EVANS	Sarah	61
CROFT	Jonah Reeve	23	EVANS	Two Daughters of Sam	78
CROFT	Mary6, 19, 23, Ch. 1, Ch.4		FRANCE	Francis	Ch.2
CROFT	Richard	23,Ch.1	FRANCE	Mercv	Ch.2
CROFT	Sarah Ann	36	GOUGH	Harriet	53
CROFT	Susanna Catherine	88	GOUGH	Isaac	53
CROFT	William Reeve	6, Ch.4	GRIFFITHS	W	66
CROFT	William	88	HOWELL	Hywel Emlyn	Ch.4
CROWE	Marie Annie	73	HUMPHREYS	Ann	52
CROWE	Mildred Miriam	73	HUMPHREYS	Annie	72
DAVES	Abigail.	50	HUMPHREYS	Edith.	76
DAVES	Anne.	11	HUMPHREYS	Edward	52
DAVES	Elizabeth	38	HUMPHREYS	John George	51, Ch.4
DAVES	Emma	95	HUMPHREYS	Juhn	76
DAVIES	Father of W	48	HUMPHREYS	Sarah	51

HUMPHREYS	Thomas	51	OLIVER	Clara Edith.	Ch.3
JONES	Amy Nora	86	OWEN	?	28
JONES	Catherine Elinor	71	OWEN	Edith Mary.	3
JONES	Child	70	OWEN	James Menzies.	15
JONES	David	71	OWEN	Janet	15
JONES	Gwendoline Cordelia	87	OWEN	John	15
JONES	Harriet	17,21	OWEN	Martha Elizabeth	3
JONES	Jane	60	OWEN	Ruth Bedward	3
JONES	John Davies.	81	PARRY	Elizabeth	84
JONES	John	20	PARRY	William Oswald.	84
JONES	Joseph Evan.	87	PREECE	James	77
JONES	Katherine Annie	87	PRICE	Mary	59
JONES	Mary	81	PRICE	Walter.	59
JONES	Mrs.	89	REEVE	see	23
JONES	Robert.	17,21,43	ROGERS	John	44
JONES	Samuel	43	SHEEN	Mrs.	67
JONES	Sarah Anne	13	WALKER	George	62
JONES	Thomas.	43, 86	WALKER	Lavinia	62
JONES	William	60	WALKER	M	65
LITTLEHALES	Elizabeth	5	WALKER	Mary Elian	62
LITTLEHALES	Henry	5	WALKER	W	65
LITTLEHALES	Humphrey	5	WILLIAMS	Jemima	85
LITTLEHALES	John	5	YELLAND	Jessie	6
MENZIES	see	15	YELLAND	Maria	Ch.4
MORGAN	Catherine Elizabeth.	71	YELLAND	Martha	63
MORGAN	Edwin	71	YOUNG	George	47
NICHOLAS	Ellen	94	YOUNG	Mary	47
NICHOLAS	Grandchild of	25			
NICHOLAS	John	94			
OLDFIELD	W	74			

Grave positions and numbers on this side of path derived from an original in the possession of the Church.

Congregational Church,
POWERSLOTT, Shropshire

Grave positions and numbers on this side of the path derived from the JONES transcript notes. (Approximate positions only)

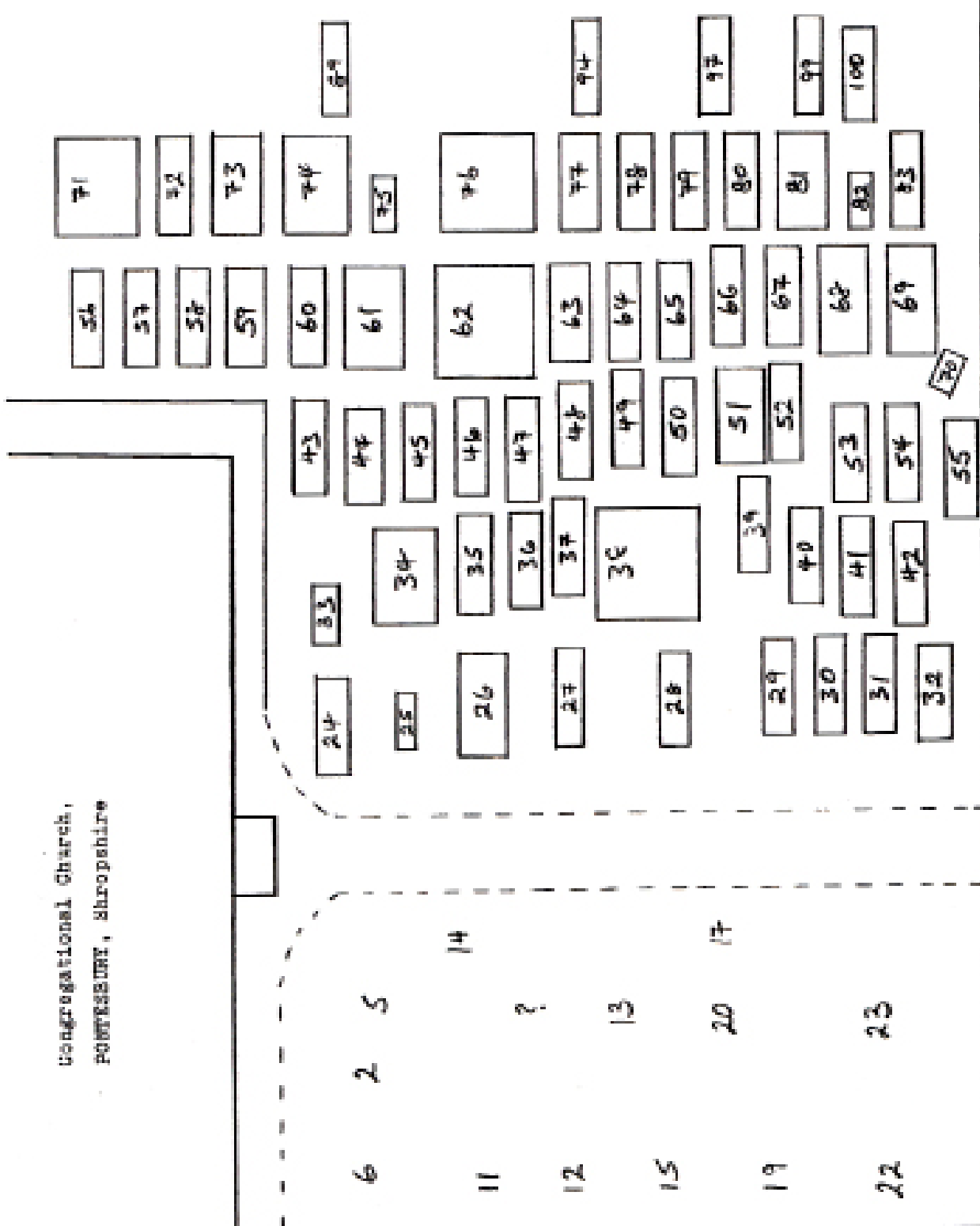

R O A A

Congregational Church, PONTESBURY, Shropshire.

Grave positions as found in 1990.

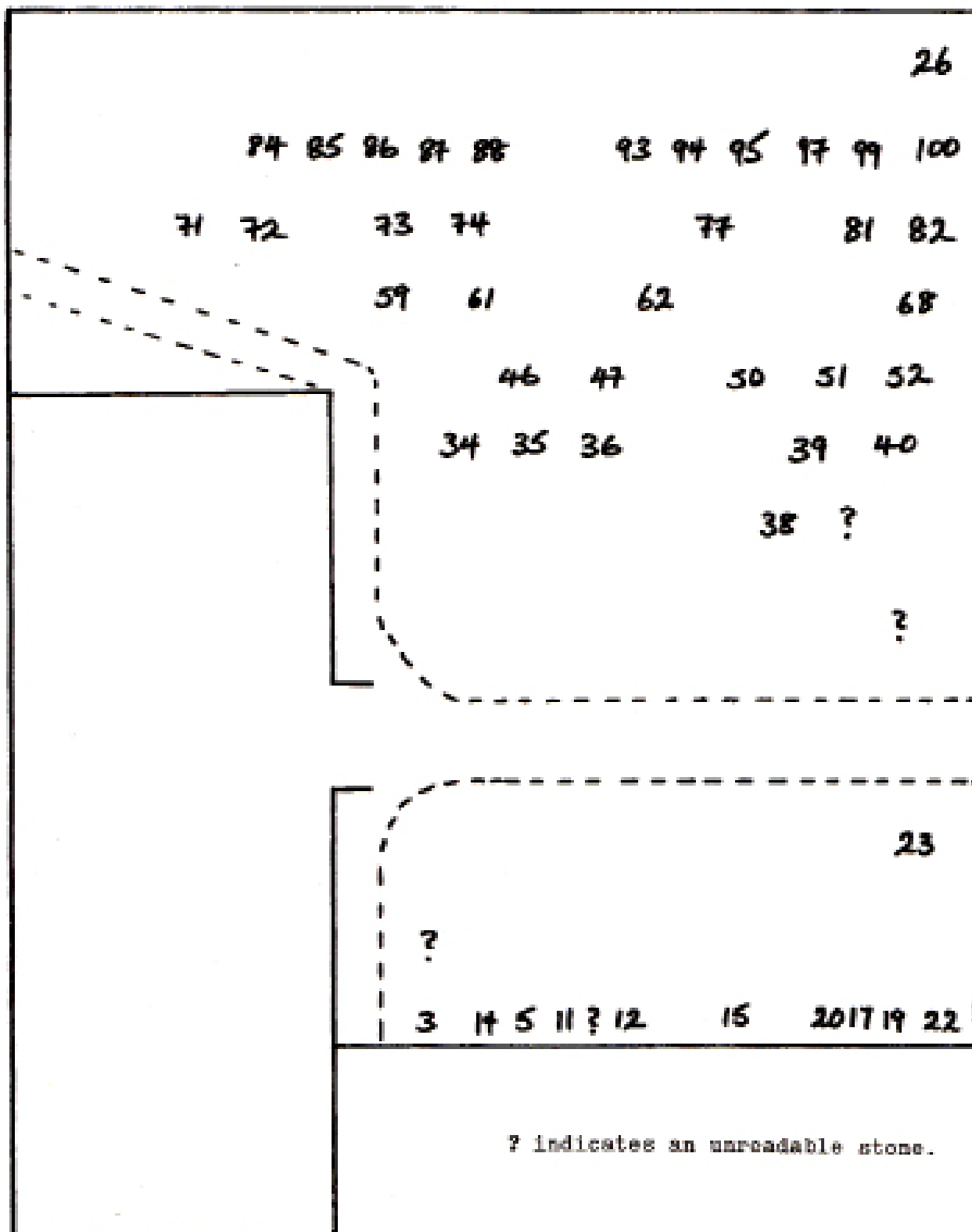

J. W. Lewis & George
1990

R O A D

? indicates an unreadable stone.

**Monumental Inscriptions at St
George's Church. PONTESBURY
Shropshire 1547-1988**

**Monumental Inscriptions at
St George's Church
P O N T E S B U R Y
Shropshire
1574 - 1988**

**Transcribed by
Denis George
1989**

**Typed by
Pat Berry**

**Re-typed in machine readable form
by Pat Gardiner
2003**

**SHROPSHIRE FAMILY HISTORY
SOCIETY
1 9 9 2**

PONTESBURY CHURCHYARD

Stones numbered 1 to 101 inclusive have been removed from their original positions, laid flat and let into the turf, on the south perimeter of the Churchyard.

- 1 Martha ... Richard ...died 23 June 1835
Also Ann wife of the above died 2 May 1876 aged 86.
- 1a Philip Jadrell GITTINS died 29 July 1888. Aged 63.
- 2 Edward BAYLEY died 3 September 1726. (stone broken through, rest Illegible)
- 3 Thomas ROGE died 16 December 1846? Aged 59.
- 4 Elizabeth daughter of William and Hannah RANGLES died 10 February 1748 aged 1 year.
- 5 No visible inscription.
- 6 Thomas S????OR
- 7 John OLIVER late of Edge in this parish, died 18 April 1813. Aged 7?5?
- 8 Thomas PUGH died 10 June 1851. aged 3.
Also William PUGH died ? April 1863. aged 18.
- 9 Joseph EDWARDS of Ascott died 28 December 1829. Aged 71.
Also Sarah his wife died 5. February. 1838. aged 78.
- 10 Elizabeth wife of Samuel SMITH and daughter of Will BOWYER died 20 May 1736. aged 29.
- 11 Jane wife of Thomas HUFFER died 7 May 1855. aged 22.
- 12 Also Margaret Jane? Widow of the later John PARRY esq: fo Hinton in this County, died 2?l?April.1839. aged 77.
Also Susanna PARRY, eldest daughter of the above died 8 June 1842. aged 59.
- 13 Humphrey PARRY youngest son of the late John PARRY of Hinton died 28 June 1834. aged 37.
- 14 Also Martha third daughter of the late John PARRY Esq: of Hinton died 23 April 1846. aged 60.
- 15 John PARRY Esq: of Hinton died 16 November 1856. Aged 68.
Also Charlotte REYNOLD died 11 March 1875. aged 8?8?
- 16 John CROSS husband of Mary died 26 October 1896. aged 47.

- 17 Humphrey JONES died 16 December 1781. aged 43?
- 18 Thomas WILLIAMS died 1 August 1854. aged 28.
Also Ann his infant daughter
Also William JAMES died 19 August 1857. Aged 13.
Also Samuel Died 14 January 1839. aged 10.
Also Mary died 1 May 1859. aged 9.
Also William died 10 January 1848. aged 10.
Also ... ,
Also Mary JAMES died ? September 1865. aged 8?8?
Also William JAMES died 16 March 1870 aged 75.
- 19 Ann PARRY died 14 January 1891 aged 61.
Also William her husband died 10 April 1898. aged 73.
- 20 James FLEET of Malehurst died 18 July 1891. aged 69.
Also Amelia his wife died 11 July 1893. aged 56.
- 21 William BREEZE (late of Asterley) died 10 December 1832. aged 67.
Also William son of John and Martha BREEZE died 1 September 1839. aged 2.
Also Martha their daughter died 16 April 1841. aged 1 year and 10 months.
- 22 Mary wife of Richard LITTLEHALES died 12 May 1786 aged 55.
Also Martha Daughter of Richard and Martha PURSLOW died 16 July 1786 aged 1 year and 5 weeks.
- 23 Richard SAY ACE died 19 October 1896 aged 85.
Also Sarah Ann his wife died 6 May 1900 aged 74.
- 24 Eleanor HOPTON of Cruckmeol died 11 January 187? aged 90.
Also John her husband late of Cruckmeol, died ? March ???? aged 90.
- 25 John William son of John and Harriet DELAMERE of Hinton died 3 . April 1893. aged 6.
- 26 Ann daughter of Stephen and Jan HILLAGE died 28 November 1819 aged 9
- 27 James son of died 14 November 1819 aged 4 months,
Also Elizabeth their daughter died 19. November 1819 aged 3,
Also Jane HILLAGE died 14 December 1834 aged 58.
Also Stephen her husband died 13 August 1844 aged 59.
- 28 Thomas KYNASTON of Plealey died 19 May 1869 aged 56.
Also Margaret his widow died 3 August 1883 aged 69.

- 29 Thomas JENKINS of Windmill Inn, Asterley died 22 June 1901 aged 68. 30
Cast iron memorial - Robert Brazenor OAKLEY died 5 January 1879 aged
62.
- 31 William son of Thomas and Mary THOMAS died 24 May 185? aged 20.
- 32 William POWELL died 19 March 1887 aged 67.
- 33 Ann daughter of David and Mary PUGH died 15 May 1831 aged 10. 34
Mary wife of Thomas THOMAS of Pontesbury died 7 September 1869 aged
67. 35 Jane wife of Stephen ELLEDGE died 16 February 1892 aged 70
- 36 John ROGERS of died .12 aged 64 37 John SAINPOLL late of Long —
died 1 March 1795 aged 47.
Also Ann his wife died at Shrewsbury 1 August 1846 aged 91.
- 38 Richd RICHARDS [Right hand side of stone flaked away] In this parish
departed this — aged 6?3?
- 39 John RICHARDS late of the Lea, died 4 May 1821 aged 30 or 36.
Also Thomas RICHARDS late of the Lea died 21 October 1843 aged
60?6?Also Mary widow of Thomas RICHARDS died 3 June 1850 aged 78.
- 40 Hannah THOMAS died 23 March 1795 aged 72.
- 41 Martha HIGGINS died 13 August 1794. aged 65,
Also Richard son of Samuel and Elizh VAUGHAN and grandson of the above
died 7 November 1817.aged ?4.
- 42 Mostly illegible but Martha died 27 179? aged ?8.
- 43 William CRUMP of Pontesbury Hill died 8 June 1879. aged 57,
Also Sarah his wife died 17 October 1869. aged 48.
- 44 Edward JAMES late ofPontesford died 13.December 1835 aged 41,
Also Edward 10 years (or months),
Also Marga ?6???
- 45 Mary wife of John LITTLEHALES, blacksmith of Longden, died 1? April 1816
aged 6?
- 46 Richard LITTLEHALES , blacksmith, late of Longden died 23 April 1781
aged 60.
- 47 Richard EVANS late of Pontesbury died 27 June 1850 (1830) ages 44.
- 48 Sarah JANDRILL died 14 December 1808 aged 78,
Also James husband 18474? aged 7?9?

- 49 James COXALL died 14 July 1867 aged 56,
Also Elizabeth his wife died 11 March 1880 aged 65.
- 50 William HAYWARD died 30 October aged 67.
- 51 Harriet PARRY died 18 October 1840 aged 10,
Also Harriet PARRY her mother died 14 February 1853?9 aged 66,
Also Samuel PARRY her father died 14 October 186- aged 78.
- 52 Samuel son of Samuel and Mary DOWNTON of Pontesbury died 9 July 1872
aged 34.
- 53 Martha GITTENS died 25 December 1850 aged 70.
- 54 Richard Betton CRUMP died 5 July 1852 aged 27,
Also Elizabeth his wife Died 9 July 1851 aged 29
- 55 Thomas HUMPHREYS died 17 January 1892 aged 71,
Also Jemima his wife died 2 September 1896 aged 72?8?
- 56 Mary wife of Samuel DOWNTON died 3 November 1876 aged 67,
Also Edwin their son died 23 March 1880 aged 30,
Also Samuel DOWNTON husband of Mary died 5 October 1896 aged 86.
- 57 Thomas NICHOLLS, 50 years Parish Clerk of Pontesbury, died 2 December
1857 aged 78,
Also Mary his wife died 25 April 1860 aged 81.
- 58 Elizabeth wife of John WILLIAMS of Pontesbury Hill died 9 February 1884
aged 63.
- 59 Sarah wife of John LITTLEHALES of Hanwood, died 11 May 1815 aged 38.
Also Mary his second wife died 20 December 183- aged 42,
Also John LITTLEHALES their husband died 31 January 1860 aged 80.
- 60 John son of John and Mary PARRY died 11 August 1877 aged 3 months,
Also John PARRY died 27—1877 aged 46,
Also Thoas PARRY died 14. March.—aged 59.
- 61 Martha BLAKEMORE died 11 February 1866 aged 75.
- 62 Mary wife of Job EDWARDS late of Stars Copey died--October—(no age)
- 63 Hannah wife of Richard CORFIELD of the Oakes in this parish died 6 May
1817 aged 72.

- 64 Thomas GLOVER late of Fords Heath died 11 October 1791 aged 67,
Also Samuel his son died in infancy,
Also Mary his wife died 15 November 1805 Aged 74.
- 65 Levi GILES died 2 October 1881 aged 51,
Also Ann his wife died 9 April 1905 aged 70.
- 66 Harriet daughter of Richard and Emma LITTLEHALES died 1 July 1849 aged
13 months.
- 67 William HALL of Pontesbury died. 15 January 1877 aged 77,
Also Martha his Wife died 17.—.1885 .
- 68 Edward JONES died 13 April 1901 aged 80,
Also Mary Ann his wife died 3 December 1901 aged 58.
- 69 Mary PUGH of Pontesbury Hill died 13 August 1846 aged 46,
Also Thomas Her husband died 1871 aged 70.
- 70 William BARBER for 24 years Parish Clerk at Pontesbury died 15 January
1884 aged 44.
- 71 Richard son of Zacharia and Susan WEBSTER died 15 May 1880 aged 25,
Also Susan his mother and widow of Richard THOMPSON of Pontesford died
7 February 1897 aged 83.
- 72 Alexander HUGHES died 12 March 1833 aged 82,
Also John son of Alexander and Martha HUGHES died 8 December 1831
aged 44.
- 73 Richd son of Richd and Mary LITTLEHALES died 21 September aged 1 year
and 8 months.
- 74 Ann wife of Edward BAYLEY died 13 March 1856 aged 43.
- 75 Thomas STEDMAN died 11 August 1852 aged 74.
- 76 John DAVIES of Pontesbury died 31 December 1861 aged 62,
Also Jane his Wife died 10 March 1889 aged 81.
- 77 Susanna daughter of David and Susanna ROBERTS of Pontesbury died 12
June 1881 aged 33,
Also Susanna ROBERTS died 19 July 1881 aged 57,
Also David her husband died 10 October 1882 aged 68.
- 78 Edward PHILLIPS of Pontesford died 19 June 1806 (no age given)

- 79 Sarah daughter of Thomas and Susan ISSARD of Mealhurst in this parish died 7 January 1851 aged 25.
- 80 Thomas ROBERTS Late of Great B—wich, farmer, died 15 March 1854 aged 44,
Also Emma wife of Robert B OAKLEY of — wern Grange, Montgomeryshire, died 16 March 1854 aged 59,
Also Alfred Edward their son died 17 July 1857 aged 8.
- 81 Susanna daughter of —JONES died 13 August 1897 aged 15.
- 82 Thomas OWENS died 4 February 1901 aged 77.
- 83 Sarah wife of Thomas OWENS died 31 August 1903 aged 64,
Also James Albert OWENS died 14 May 1900 aged 19.
- 84 Anne widow of the late William OWENS died 26.November,1840 aged 82.
- 85 Sarah JONES died 18 May 1854 aged 83,
Also Mary TIPTON died 4 January 1867 aged 88.
- 86 Marta his daughter died -June. 183-,also Sarah his daughter died 30. January. 1817 daughter of John died 1 April 1811 aged 12.
- 87 Mary GITTINS of this parish died 27 December 1855 aged 62,
Also Abraham her husband died 27 January 1867 aged 84. 8
- 8 John VAUGHAN died 19 March 1857 aged 77,
Also Eleanor his wife died 6 December 1856 aged 76.
- 89 Richard TIPTON died 18 January 1852 aged 77.
- 90 James CORFEELD formerly of the Oakes, late of Longdon died 18.May 1842. aged 68,
Also Elizabeth his widow died 26 May 1850 aged 79.
- 90a Jane OWENS died 23 June 1902 aged 72. 90b. Catharine wife of Thomas OWENS of Pontesbury died 5 August 1856 aged 25,
Also Mary Catharine their daughter died 4 June 1900 aged 45.
- 91 Elizabeth wife of Arthur Davies BOYER of Pontesford died 16 June 1839 aged 25.
- 92 Arthur Davies BOYER died 27 February 1843 aged 54.
Also Jane Ellen his daughter died 5 March 1847 aged 12.

- 93 Sarah Jane Bertha daughter of Thomas and Sarah OWENS of Polesmore died 14 August 1871 aged 2 years and 4 months,
Also Jane BREEZE daughter of the late John BREEZE of Minsterley died 5 January 1889 aged 52.
- 94 John VAUGHAN late schoolmaster of Pontesbury, died 24 June 1791 aged 57,
Also Sarah daughter of John and Eleanor VAUGHAN died 13 June 1861 aged 39,
Also John VAUGHAN (of Pontesbury) died 1 May 1871 aged 57.
- 95 Richard TIPTON late of Longden Wood died 24 February 1895 aged 67,
Also Ann his wife died 3 February 1918 aged 89.
- 96 Benjamin TIPTON late of Shrewsbury died 19 July 1843 aged 78.
- 97 Thomas BLAKEWAY died 25 January 1837 aged 80,
Also William his son died 18 April 1808 aged — 97a Thomas MEREDITH
(no further details)
- 98 Martha wife of John BLAKEWAY of Pontesbury died 12 April 1900 aged 78
- 99 Elizabeth wife of Edward LEWIS of Pontesbury died 25 February-aged 578?
- 100 Elizabeth wife of Richard TIPTON died 20 May 1850 aged 77.
- 101 Ann Maria TUCKER of Shrewsbury died 30 December 1858 aged 59.
- 102 Heighway JONES of Earlsdale died 6 May 1876 aged 58,
Also Mary his wife died 30 September 1890 aged 79,
Also Eliza Mary HEIGHWAY died 1889 aged 69,
Also Henry JONES of Karratto, South Australia died 1881 aged 68

- 103 Samuel HEIGHWAY Esq. OfPontesford died 14 February 1815 aged 33,
 Also William HEIGHWAY born 3 June 1751 died 26 October 1807 aged 58,
 Also Jane his wife died 1826 aged 72,
 Also Samuel HEIGHWAY their son born 1781 died 18 February 1813 aged
 33,
 Also Elizabeth HEIGHWAY born 1785 died 1867,
 Also Mary HEIGHWAY born 1787 died 1849,
 Also Samuel born 1788 died —, William JONES of Shrewsbury died 1841
 aged 62,
 Also Catherine his wife and daughter of William HEIGHWAY ofPontesford
 died 1835 aged 52,
 Also William HEIGHWAY JONES died 1841 aged 34,
 Also Frederick JONES died 1861 aged 50,
 Also Catherine HEIGHWAY died 1835 aged 52,
 Also William HEIGHWAY born 1784 died 1833 aged 59, William HEIGHWAY
 Esq ofPontesford died 26 October 1809 aged 69,
 Also Jane his wife died 1 May 1820 aged 71,
 Also Jane wife of John JAMES died 26 August 1805 aged 30.
- 104 Frances Catherine HEIGHWAY died 1890 aged 88,
 Also Derwas Owen JONES died 1907 aged 84,
 Also Eliza his wife died 1887 aged 63,
 Also Heighway JONES of Earsdale and Habberley died 1916 aged 69,
 Also Mary Jane HEIGHWAY JONES died 1927 aged 76.
- 105 John BARKER died 1?October. 1787? aged 67?
- 105a William ICKE late of Pavement Gates died 24 April 1838 aged 77.
- 105b John PROBERT late of Strangworth Forge in the county of Hereford, died 18
 July 1788 aged 35.
- 105c Edward RUBBATHAN died 30 May 1840 aged 64.
 Also Elizabeth his widow died 15 July 1853. aged 82. 105d. Thomas son
 of Richard and Hannah CORFIELD The Oakes, died 19 February 1809 aged
 56.
- 106 Illegible.
- 107 A DEO DATUS - Anthony BARRON only son of Robert Edward and Ann
 BARRON of Yockleton Park in this county, died 24 July 1874 aged 64.
- 108 Ann BARRON eldest daughter of the late Richard NICHOLLS of Yockleton
 Park, died 22 March 1860 aged 74.
- 109 Illegible.

- 110 Richard NICHOLLS of Yockleton Park died 27 March 1829 aged 707,
Also Ann his wife died 23 August 1842 aged 78,
Also John NICHOLLS died 22. December. 1829 aged 40,
Also Harriot daughter of Richard and Anne NICHOLLS died 4 April 1847.
- 111 Mary wife of Robert NICHOLLS Esq, of Aston Hall died 7 March 1819 aged 75,
Also Mary her daughter died 3 May 1817 aged 31, Robert NICHOLLS Esq,
died 27 April 1834 aged 73,
Also Elizabeth his daughter died 22 January 1840 aged 49, Thomas Jones NICHOLS Esq, of Yockelton Hall born 17. October. 1837 died 23 November 1874 aged 37, Thomas NICHOLS Esquire (late of Aston Hall) died 17 March 1838 aged 54,
Also Margaret Minor NICHOLS his widow died 17 June 1876 aged 77.
- 112 Thomas NICHOLS died 3 May 1856 aged — 113 Thomas NICHOLS of Yockelton Hall died 7 November 1809 aged 44,
Also Margaret his widow died 15 September 1846 aged 80.
- 114 Ann DOLPHIN daughter of the late Saml and Ann DOLPHIN died 13 May 1789 aged 31.
- 115 Illegible
- 116 John LANGSLOW of Earlshill died 2 December 1857 aged 37,
Also Mary SPENCER his wife died 10 June 18-0 aged 69.
- 117 Sarah daughter of John and Elizabeth LLOYD of Nox died 7 June 18376 aged 73.
- 118 Mary Jane HALLIWELL only daughter of Rev. Emilius NICHOLSON late Incumnet of Minsterley, Salop died 8 January 1862 aged 31.
- 119 John JONES of Pontesbury died 3 September 1877 aged 63. 120 Illegible
- 121 Mary JONES died 14 May 1847/1817 aged 47.
- 122 Illegible
- 123 Norman WALKER died 25 January 1842 aged 13.

- 124 John NICHOLLS of Newnham, Gentleman died 9 September 1809 aged 56.
Also Anne his widow died 26 May 1846 aged 79,
Also Anne Eleanor their eldest daughter died 2- June 1845/1815 aged
60. John NICHOLLS of Newnham, Gentleman, eldest son of John and Ann
NICHOLLS died 27. December. 1850 aged 61,
Also Mary youngest daughter of Richard and Anne NICHOLLS died 13
March 1849 aged 61, Edward Owen youngest son of Richard and Anne died
— December 1813 aged —
- 125 Elizabeth PEACOCK died 4 August 1844 aged 5787,
Also George PEACK died 10 February 1852 aged 52.
- 126 Edward OWEN of St Asaph, Flintshire died 5 September 1845 aged 57370.
- 127 Harold FORTUNE (size of grave indicates infant)
- 128 William Lightfoot HARRISON rest illegible - cast iron drawf railing surround.
- 129 Cast Iron tall obelisk - Rev Hamlet HARRISON late Fellow Brasenose
College, Oxford, Rector of Pontesbury first portion and of Stretford-le-Bow,
Middlesex died 2 October 1845 aged 77,
Also Elizabeth HARRISON died 18 February 1875 aged 46, Francis Ann wife
of Rev W HARRISON rector of Pontesbury first portion died 29 October
1863 aged 33, Rev William HARRISON rest illegible.
- 130 Sarah HARRISON died at The Deanery Pontesbury 21 February 1896 aged
71.
- 131 James husband of Liza STEVENS died 5 November 1883 aged 25,
Also Martha and Mary their infant sisters,
Also Jane STEVENS his sister died 20 February 1885 aged 2 years and 4
months,
Also William STEVENS his Father died 25 February 1891 aged 59.
- 132 John DA VIES died 15 July 1827 aged 25,
Also Sarah DA VIES died 10. October. 1832? aged 21.
- 133 Edwin son of Robert and Harriot ROGERS died 12 July 1852 aged 4 years
and 11 months,
Also Edward another son died 3. September aged 27,
Also John JONES son of the above died 3 April 1866 aged 24.
- 134 Janet Maureen TEAGUE died 18 April 1981 aged 47.
- 135 William Albert DAVIES died 30 September 1981 aged 44.

- 136 George MILWARD died 12 May 1986 aged 70, Hilda MILWARD died 10. January. 1984 aged 72.
- 137 Samuel Charles, son of Samuel and Ann DAVIES died 9 January 1881 aged 2 years and 6 months.
- 138 Emma PHILPOTT of Pontesford died 1 April 1881 aged 56,
Also Harriett CRUMP her sister died 22 December 1897 aged 74.
- 139 Benjamin PHILPOTT of Pontesford died 2 April 1872 aged 79,
Also Ann his wife died 15 February 1873 aged 78.
- 140 Ann HARRIS died 24 December 1867 aged 68 (covered with turf)
- 141 Sarah PHILPOTT (of Pontesford) died 3 May 1873 aged 46,
Also Charles her husband died 21 June 1895 aged 76.
- 142 Eliza Jane, daughter of Samuel and Ann DAVIES died 21 April 18-9 aged 4,
Also Samuel DAVIES died 3 October 1900 aged 64.
- 143 Eliza MORRIS daughter of John and Margaret TIPTON, late of Red House Pontesbury, died 3 July 1893 aged 39,
Also Sarah Jane BROXTON their daughter die 10 September 1898 aged 53,
Also Henry their son died 7 September 1883 ages 36,
Also Agnes Lora their daughter died 3 .December 1884 aged 16,
Also Margaret Alice their daughter died 21 August 1891 aged 27.
- 144 Chalotte Helen SAWTELL 1903-1983.
- 145 John RANGLES died 12 June 1848 aged 88,
Also Eleanor his wife died 14. November. 1851 aged 83 (covered with turf)
- 146 George PEACOCK died 12 April 1898 aged 78.
- 147 Thomas EVANS late of Hill Farm died 13 December 1892 aged 93,
Also Elizabeth his wife died 29 January 1891 aged 90.
- 148 M.S. 25.4.1852, 29, S.S. 18.6.1852 4 months.
- 149 John EDGERLEY late of Liverpool died 4 November 1895 aged 51. 150
Mary Ann youngest daughter of W & C M EDWARDS of Pontesford died 14
October 1897 (no age given)
- 151 Richard EDGERLEY died 15 June 1868 aged 58,
Also Sarah his wife died 26 July 1885 aged 74,
Also Eliza WILLIAMS their daughter died 14 April 1873 aged 37.

- 152 Eleanor DA VIES died 9 December 1854 aged 75,
Also Richard her husband (late of Pontesbury) died 26 March 1867 aged 93.
- 153 Ann EDWARDS of Lea Cross, Post Office died 25 January 1884 aged 63.
- 154 Margaret wife of William GUILLIAM died 1 March 1872 aged 51,
Also William GUILLIAM died 15 February 1882 aged 62,
Also Louisa their daughter died 27 January 1864 aged 5.
- 155 Alice only daughter of William and Jane PUGH (late of Edge) died 2 April 1892 aged 36.
- 156 Ann wife of Thomas BROWN died 8 July 1876 aged 57.
- 157 Robert M FUSZARD died 2 November 1855 aged 26.
- 158 John MEDLICOTT died 3.November, 1859 aged 24.
- 159 Thomas son of William and Elizabeth ANDREWS of Boycott, born 6 December 1856 died 1 November 1864.
- 160 Ann DIGGORY (late of Lea Cross) died 22 March 1859 aged 98.
- 161 John DAVIES of Boycott died 2 February 1901. (no age given)
- 162 Willliam DAVIES of The Grange, Pontesbury died 6.Febraury.l881 aged 58
Also Hannah DAVIES his widow died 29 September 1897 aged 70.
- 163 Top of stone missing —ber. 13.1866 aged 34,
Also George son of the above died 1 May 1867 aged 6,
Also Sarah daughter of the above died 4. September 1880 aged 16.
- 164 George JACKS died 11 May 1869 aged 56,
Also Charlotte his wife died 3 March 1876 aged 60.
- 165 Mary BROMLEY died 25 November 1887 aged 76,
Also William of Pontesbury her husband, died 10 March 1888 aged 84.
- 166 William BROXTON, Brook House, Pontesbury died 14 February 1876 aged 58,
Also Sarah his wife died 24 June 1878 aged 62.
- 167 Mary Ann daughter of William and Sarah BROXTON died 20 March 1862 aged 20,
Also William their son died 30 March 1870 aged 26.
- 168 Sarah second daughter of William and Mary BROXTON late of Yockleton,
Died 9 November 1862 aged 42.

- 169 Edward ROGERS died 15 December 1861 aged 27.
- 170 Ann wife of Job NICHOLLS died 22 December 1849 aged 22,
Also Anna their Daughter died 10 September 1850 aged 9 months,
Also Emma second wife of Job NICHOLLS died 24 June 1859 aged 28,
Also Job NICHOLLS died 1 December 1886 aged 61.
- 171 Richard ROBERTS died 6 August 1867 aged 64,
Also two of his sons, William died 10 August 1860 aged 21, and Samuel
died 21. November 1867 aged 37.
- 172 Elizabeth daughter of John and Jane ADAMS born 2 October 1842, died 21.
November. 1879.
- 173 John WILKINSON late of Plealey died 21 April 1863 aged 66,
Also Mary his widow died 9 January 1875 aged 73.
- 174 James BUCKLEY of Pontesbury died 18 October 1875 aged 39.
- 175 James BOWERS of Plealey died 5 February 1868 aged 58,
Also Thomas son of Thomas and Mary Ann BOWERS and grandson of the
above died 16, April. 1885 aged 11,
Also Sarah widow of James BOWERS died 21. October. 1888 aged 77.
- 176 Matilda EDWARDS of Pontesbury Hill died 5 18-4 aged 2- years,
Also Margret wife of William HAMPSON (and of the above) died 4 January
1885 aged 69.
- 177 Richard BEDWARD (of New Mills, Pontesbury) died 3 March 1870 aged 77.
- 178 John ADAMS died 1 August 1880 aged 60.
- 179 William VAUGHAN 36 years Rector of the 3rd portion of this parish died 26
November 1866 aged 67.
- 180 Charles DRURY 45 years Rector of Pontesbury 2nd portion died 15. January
1869 aged 81.
- 181 Ellen wife of Steph JONES Lea Farm, died 12 December 188- aged 42.
- 182 Cyril William HIGHLEY died 2 October 1959 aged 52.
- 183 John Frederick Williams LEA of The Hollies Farm, Gatten, died 20 April
1900 aged 40.

- 184 Edward Mainwaring FURLEY Rector of Pontesbury 3rd portion, died 23 February 1895,
Also Edward Mainwaring FURLEY M. A., for 30 years Rector of this parish born 3 December 1843 died 27 February 1914.
- 185 James RANGLES died 10 February 1889 aged 82,
Also Martha RANGLES his daughter died 17 August 1886 aged 28.
- 186 John WEBB died 30 August 1889 aged 62,
Also Mary his wife died 18 August 1896 aged 81.
- 187 Rev Samuel John Abbot HAWKES M.A. 40 years Rector of Pontesbury 2nd Portion, born 11 June 1835 died 23 October 1909,
Also Anne Jane HAWKES born 4 February 1831 died 28 October 1916.
- 188 Ann HAWKES born 1 February 1796 died Ascension Day 1882.
- 189 Rev. Herbert Maynard SMITH D.D. Canon Residentiary of Gloucester Cathedral 1921-1946, died at Pontesbury Manor 6 January 1949 aged 79.
- 190 Charles EDGERLEY of Lea Cross died 7 December 1902 aged 53. Metal plates on various rose beds. 191 John OWEN Parish Councillor 1969 - 1985
- 192 Bill DA VIES died 26 October 1985. 193 Cecil SYLVESTER 1898 - 1977 and Hilda SYLVESTER 1897 - 1987
- 194 Lesley TOMKINS born 17 September 1942 died 28 November 1979
- 195 Ernest HUMPHREYS born 18 February 1895 died 7 January 1975.
- 196 Ethel Mary HUMPHREYS born 19 January 1898 died 28 September. 1978.
- 197 H G Alan EVANS died 4 October 1963 aged 81,
Also Elsie Maud EVANS died 23 February 1976 aged 76.
- 198 Jacqueline (Jackie) Lesley MIDDLE born 20 October 1967 died 27 February 1971 aged 3.
- 199 Edward KEY, Highfield.
- 200 Not used.
- 201 Lucy wife of Edward JONES of Deganwy, died 3 May 1915 aged 25,
Also William JONES her father died 23 May 1916 aged 48.
- 202 John HAYWARD of Malehurst Farm, died 23 December 1912 aged 60,
Also Elizabeth Jane (Cissie) died 27 December 1914 aged 13,
Also Sarah Jane his Wife died 17 April 1935 aged 78.

- 203 Richard Clement BREEZE died 26 December 1902 aged 37.
- 204 Arthur Noel GILES killed in action 28 June 1916 aged 20,
Also Joshua GILES died 14 November 1917 aged 55,
Also Eliza his wife died 25 November 1943 aged 84. 205 Mary Ann
HALFORD of Pontesbury Hill died 9 May 1903 aged 70.
- 206 Eliza wife of Thomas EVANS died 4 May 1914 aged 79.
- 207 Hilda Marian GILES died 28 December 1911 aged 9,
Also Elsie Sarah GILES died 8 March 1912 aged 17.
- 208 Laura GILES died 19 March 1915 aged 16. 2
- 209 Martha widow of Thomas WEAVER died 20 January 1901 aged 88.
- 210 Joseph EVANS died 13 October 1901 aged 86.
- 211 Zachariah WEBSTER of Pontesford died 27 June 1911 aged 87,
Also Susan his wife died 7 February 1897 aged 83,
Also Mary their daughter and wife of John ROGERS of Plealey died 21
October 1924 aged 73.
- 212 William WARTER died 7 July 1900 aged 74, interred in the old churchyard,
Also Elizabeth his wife died 7 February 1911 aged 92,
Also James WARTER their son died 14 December 1924 aged 66.
- 213 Curbs, but no apparent inscription.
- 214 Henry EVANS of Pontesford died 1 December 1896 aged 76,
Also Elizabeth his widow died 24 August 1911 aged 87.
- 215 Martha Elizabeth BOWEN of White Horse, Pontesbury died 15 April 1904
aged 29,
Also Joseph her husband died 12 December 1906 aged 35.
- 216 Benjamin THOMASON died 5 January 1908 aged 78,
Also Martha his wife died 29 October 1910 aged 77.
- 217 William BROMLEY of Plealey died 12 June 1910,
Also Mary his widow
- 218 Henry JONES of Plealey died 17 September 1910 aged 74,
Also Susan his wife died 29 November 1918 aged 92.
- 219 Susan PRICE died 4 June 1913 aged 90,
Also Harriet daughter of the late Richard and Susan PRICE of Pontesbury
died 7 August 1910 aged 50.

- 220 Christina GITTINS of Pontesbury died 27 June 1914 aged 80
- 221 Charlotte HEIGHWAY (Siberscote) died 26 December 1904 aged 32,
Also Robert HEIGHWAY died 29 July 1915 aged 81,
Also Charlotte his wife died 25 July 1924 aged 82,
Also Ida HEIGHWAY their daughter died 5 May 1967 aged 93.
- 222 Samuel JONES Wharf Pontesbury died 3 October 1909 aged 74,
Also Elizabeth his wife died 10 May 1914 aged 85. 2
- 23 Kate FORTUNE Ingleside, died 28.Decmber.1911 aged 42,
Also Thomas her husband died 19 March 1915 aged 60.
- 224 Thomas HENRY son of Thomas and Kate FORTUNE Ingleside died 1.
February 1919 aged 22.
- 225 2717 Pte A C B DAVIES, K S LI, died 10 September 1915 aged 20.
- 226 Thomas Butler DAVIES died 27 April 1912 aged 49,
Also Eliza his wife died 16 May 1943 aged 75.
- 227 Martha widow of E COXALL died 18 August 1915 aged 62
- 228 Winifred Anne, only daughter of Henry and Louise CHALLINOR Pontesbury
died 18 November 1917 aged 6.
- 229 Kathleen Winifred (Winnie) daughter of Lambert and Elizabeth MASSE died
2 March 1915 aged 3 years.
- 230 Curbs, no apparent inscription.
- 231 Benjamin THOMASON Pontesford died 27 January 1912 aged 55,
Also Ann his wife died 13 April 1945 aged 85.
- 232 John Edward LEWIS Plealey died 27 October 1919 aged 7,
Also Charles CRUMP 1912 (no age given)
- 233 William LYCETT Gladstone Cottages, Pontesford Hill died 11 May 1913 aged
72,
Also Elizabeth his wife died 26 January 1915 aged 72.
- 234 Helen (Nellie) TUDOR of Polemere born 2 February 1872, died 13 July
1917,
Also Joseph TUDOR born 14 March 1872 died 20 June 1953.
- 235 Adam CHALLINOR died 22 December 1911 aged 45,
Also Sarah his wife died 21 June 1949 aged 84.
- 236 Martha HUNTER died 27 October 1910 aged 65.

- 237 Naomi daughter of Thomas and Ann TAMS Pontesbury died 4 April 1910 aged 20,
Also Thomas TAMS died 3 April 1918 aged 64,
Also Ann his wife died 21 April 1925 aged 66.
- 238 Emma CHALLINOR of Pontesford died 24 February 1910 aged 75,
Also Adam her husband died 27 April 1916 aged 82.
- 239 Thomas TIPTON of Brookside Farm Pontesford, died 10 July 1908 aged 47,
Also Agnes his wife died 31 July 1936 aged 78,
Also Annie Louisa their daughter died 22 July 1957 aged 71.
- 240 Margaret widow of John TIPTON died 17 March 1908 aged 83.
- 241 Richard PUGH of New House Pontesbury Hill, died 23 March 1909 aged 56,
Also Elizabeth his wife died 25 August 1941 aged 87,
Also Mary Jane (Pollie) their daughter died 13 August 1941 aged 66.
- 242 Thomas EDGERLEY died 23 March 1908 aged 85,
Also Harriet his wife died 29 August 1916 aged 72.
- 243 Dora Ellen BELL died 5 February 1919 aged 8.
- 244 Ann SPENCER of Pontesford died 22 January 1910 aged 68,
Also William her husband died 9 July 1913 aged 78.
- 245 Doris daughter of George and Harriett ANDREWS Shore Hill died 11 May 1916 aged 20.
- 246 William Edward son of Thomas and Ellen HEIGHWAY died 1 October 1918 aged 20.
- 247 John THOMPSON Pontesbury Hill died 27 November 1908 aged 54,
Also Martha his wife died 21 January 1929 aged 71.
- 248 George BIJRNEY died 25 September 1912 aged 65,
Also Anne his wife died 29 September 1915 aged 69.
- 249 Thomas GWILLIAM of Pontesford Hill born 10 September 1846 died 9 May 1913.
- 250 Annie daughter of the late Henry WIBBERLEY and Sarah Ellen his wife, of Stretton, Derbyshire, died Friday 17 April 1908 aged 37.
- 251 Sophia ROBINSON ofS Pontesford died 26 April 1913 aged 49,
Also John her husband died 9 December 1923 aged 64.

- 252 Thomas JONES of Pontesbury born 21 January 1836 died 25 May 1912,
Also Anne DAVIES died 23 January 1942 aged 84.
- 253 Reginald Charles BENNET died 23 July 1915 aged 46.
- 254 Louisa FALLOWS died 11 July 1914 aged 68,
Also Charles LLOYD her brother died 8 February 1921 aged 71,
Also Caroline Ann LLOYD their sister died 21,march. 1933 aged 71.
- 255 Eliazabeth EVANS mother, late of Pontesford Hill died 11 June 1915 aged
57,
Also Herbert her husband died 11 September 1925 aged 71.
- 256 Helen RILEY born 28 February 1882 died 15 January 1915,
Also James Woodward RILEY (Eng) LRCP Edin. Esquire of the Order of St
John of Jerusalem, England, born 20 September 1852. died 6 April 1926.
- 257 Frances CORFIELD aged 2 (no dates given)
- 258 Robert CORFIELD died in infancy (no dates given)
- 259 Annie (Nancy) daughter of Sarah and the late Richard ASTON, Staylitttle,
Mont., aged 25 (no dates given)
- 260 Helen Margaret PARRY of Roseville Pontesbury, died 12 August 1920 aged
70,
Also William her husband died 23 April 1932 aged 82.
- 261 William son of the late John and Mary E TITLE Y Asterley, died 21 October
1922 aged 36.
- 262 Margaret HUGHES (Lea) died 15 August 1923 aged 78,
Also Isaac HUGHES died 1 March 1932 aged 85.
- 263 Frances FLEET third daughter of the Late James and Amelia FLEET
ofMalehurst Farm died 18 April 1924 aged 54,
Also Sarah Ann FLEET died 25 December 1927 aged 70.
- 264 Curbs, no inscription apparent.
- 265 Susan EVASON of Nesscliffdied 30 December 1924 aged 88,
Also Thomas her husband died 16 July 1930 aged 94.
- 266 John Bowen second son of JB and M JONES of Pontesbury died 14.
November. 1897 aged 6,
Also John Bowen JONES died 18 April 1924 aged 62,
Also Leonard his son who fell at Gallipoli 3 May 1915 aged 20,
Also Mary his wife died 20 June 1956 aged 93.

- 267 David husband of Agnes JONES died 27 July 1925 aged 53,
Also T and E LOCKLEY (no other details)
- 268 William TIPTON died 23 May 1925 aged 71,
Also Ada Jane his wife died 28 August 1953 aged 87.
- 269 Reece John PUGH Hawthorne Cottage, Pontesbury Hill died 31 March 1925
aged 77,
Also Mary his wife died 15 March 1938 aged 85.
- 270 William HIGGINSON Radlieth died 11 February 1929 aged 78,
Also Mary his wife died 21 December 1938 aged 78.
- 271 Thomas WILLIAMS died 28 October 1929 aged 63,
Also Margaret his wife died 12 June 1935 aged 61.
- 272 William ANDREWS the Villa Pontesbury died 2 June 1928 aged 74,
Also Mary Ann his wife died 21 May 1934 aged 80.
- 273 Jane CRUMP Lime Street, Shrewsbury died 22 March 1928 aged 41.
- 274 Richard Edward EDGERLEY died 26 October 1927 aged 54.
- 275 Mary Ann widow of Joseph CASEWELL MRVS, L&EFVMA of Wellington, died
17 August 1927 aged 67,
Also John B CASEWELL Veterinary Practitioner died 18 February 1965 aged
84,
Also Doris widow of John died 9 October 1985 aged 84.
- 276 William LOCK died 26 December 1931 aged 43,
Also Sarah Jane his wife died 12 July 1984 aged 95 (Violin Emblem)
- 277 George ANDREWS Shorthill died 14 February 1936,
Also Harriett died 7. April 1931 (no ages given)
- 278 John CHALLINOR died 9 May 1936 aged 47,
Also Alice his wife died 9 June 1952 aged 65.
- 279 Mary ANDREWS died 2 January 1934 aged 70,
Also Francis her husband died 20 January 1934 aged 68,
Also Hilda Mary BRISTOW their daughter died 12 September 1951 aged 57,
Also George BRISTOW 29 March 1964 aged 74,
Also Minnie MARSHALL died 17 July 1961 aged 60.
- 280 Curbs, no inscription apparent.
- 281 Jack CARSWELL died 13 May — aged 13.

- 282 Curbs, no apparent inscription.
- 283 William MIDDLE died 17 August 1932 aged 64.
- 284 Edwin RANGLES died 19 July 1936 aged 81,
Also ?Martha RANGLES died 29 September 1938 aged 92.
- 285 Richard Edwin CARSWELL died 4 February 1935 aged 44,
Also Mary Elizabeth his wife died 9 February 1959 aged 67.
- 286 Clara Olive JONES Pontesbury died 9 May 1935 aged 21.
- 287 Ernest G JONES died 3 September 1936 aged 65, Erected by the Rea Valley
United Choir, Past and Present.
- 288 Thomas husband of Hannah PUGH died 9 February 1911 aged 60, interred
at Shrewsbury,
Also Hannah PUGH died 10 March 1934 aged 87,
Also their daughter Jessie HAINES died 23 September 1956 aged 77,
Also Edward her husband died 25 January 1968 aged 92.
- 289 Blanche Ada DELBRIDGE died 12 February 1934 aged 42.
- 290 Joe and Fanny CHALLINOR (no further details)
- 291 Edwin husband of Caroline EVANS Quarry House, Pontesbury Hill died 19
May 1937 aged 49.
- 292 Harry PUGH died 26 August 1936 aged 44,
Also Christiana his wife died 27 October 1982 aged 89.
- 293 William STEPHENS died 5 July 1935 aged 69,
Also Annie Elizabeth STEPHENS died 19 April 1945 aged 76,
Also Arthur STEPHENS died 2 February 1945 aged 37,
Also Harry STEPHENS died 28 April 1968 aged 67,
Also Harriett Mary his wife died 19 December 1973 aged 73,
Also Elizabeth Mary JONES (Bidly) died 4 March 1965 aged 61,
Also Tom her husband died 27 March 1982 aged 87.
- 294 Elsie Winifred TOMLINS died 14 July 1940 aged 22.
- 295 George Ernest EVANS died 9 December 1948 aged 70,
Also Esther Annie his wife died 21 March 1971 aged 88.
- 296 Lillie Minnie EDWARD
- 297 Alfred CLEAVER died 3 January 1940,
Also Mary his wife died 11. September 1947.

- 298 Mary (Polly) DOWNES died 3 December 1938 aged 70,
Also Edward her husband died 5 November 1960 aged 86.
- 299 Eliza OAKLEY Lea Cross died 18 May 1938 aged 59, also Timothy her
husband died 10 February 1961 aged 85.
- 300 Thomas WOOD died 18 October 1937 aged 79,
Also Edith Jane his wife died 29 April 1961 aged 92.
- 301 Martha PALMER died 23 July 1950 aged 79,
Also Samuel her husband died 4 May 1951 aged 83.
- 302 William ~th~ HUGHES died 8 May 1941? aged 86. 303 Alice Anne HOWELL
died 22 May 1948 aged 77,
Also Mary BARKER her sister died aged 74 (no date given)
- 304 Jemma FLEET of Ellerdine died 11 November 1939 aged 68,
Also Emma FLEET her sister died 12 May 1947 aged 68.
- 305 Curbs, no inscription. 306 Curbs, no inscription.
- 307 George A T HYDE died 10 January 1943 aged 56,
Also Winifred his wife died 18 April 1977 aged 90.
- 308 William COOPER died 22 October 1943 aged 63,
Also Mary Ann his wife died 6 January 1972 aged 89,
Also Jack son and brother died 7 June 1978 aged 61.
- 309 Fanny STEADMAN died 1 December 1943 aged 73,
Also John her husband died 12 December 1944 aged 71.
- 310 Amelia GRIFFITHS Heath House, Stanton, Shrewsbury died 7 January 1943
aged 75,
Also Edward her husband died 28 January 1948 aged 75.
- 311 2220400 George CHALLINOR Air Gunner RAFVR, died 5 November 1944
aged 22,
Also Sarah GOODWIN died 25 November 1944 aged 73,
Also Evelyn CHALLINOR wife and mother died 28 December 1961 aged 69,
Also Samuel Geroge CHALLINOR died 14 May 1968 aged 73.
- 312 Mary Ann JONES died 22 January 1944 aged 75,
Also William Edward JONES her husband died 23 December 1958 aged 73.

- 313 Florence Annie PUGH 'Ollie' of Hawthorne House, Pontesbury died 20 December 1943 aged 48,
Also Reece John PUGH of Hawthorne House, Pontesbury died 14 April 1955 aged 83,
Also Caroline his wife died 31 December 1956 aged 81.
- 314 14831291 Rifleman D (Don) MARSHALL The Cameronians, died 28 July 1946 aged 19.
- 315 John LEWIS Nind Farm, Gravels died 27 December 1946 aged 63,
Also Hannah his wife died 25 May 1966 aged 82.
- 316 Richard William PUGH (of Hawthorne Cottage, Pontesbury Hill) died 17. March. 1946 aged 52,
Also Lena his wife died 5 November 1972 aged 77.
- 317 CWP 318 Charles SANKEY died 18 April 1946 aged 57,
Also Reg died 8 January 1961 aged 46.
- 319 Martha Alice PERKINS died 12 May 1946 aged 60.
- 320 Lily Elizabeth POWELL died 20 September 1946 aged 46,
Also Samuel Alfred POWELL died 13 September 1963 aged 62.
- 321 William Norman BENNETT died 4 November 1949 aged 39.
- 322 Alfred CHALLINOR died 29 May 1948 aged 75,
Also Mary Elizabeth died 27 November 1959 aged 84.
- 323 William Watt WYNESS died 21 August 1949 aged 64,
Also Sarah Ellen his wife died 8 January 1973 aged 85. 324 William BENNETT died 24 September 1949 aged 74,
Also Edith his wife died 3 May 1965 aged 72.
- 325 Martha Muriel THOMASON died 19 April 1953 aged 57.
- 326 Henry ELKES died 22 March 1955 aged 79,
Also Annie Elizabeth his wife died 9 April 1957 aged 75.
- 327 William E HARTSHORN of Plealey died 3 February 1953 aged 72,
Also Harriet Elizabeth his wife died 4 August 1974 aged 84.
- 328 Vernon Howard TOMHOLT died 14 January 1953 aged 48,
Also Merle Tamar his wife died 21. Janaury.1957 aged 56.
- 329 William ELLIS died 11 January 1953 aged 78,
Also Mary Jane his wife died 11 October 1959 aged 82.

- 330 James SMOUT died 12 July 1951 aged 67,
Also Emma Eunice his wife died 14 October 1960 aged 60.
- 331 Percy THOMASON husband died 5 March 1984 aged 74.
- 332 John PRYCE JONES Field House, died 13 February 1954 aged 87,
Also Amelia his wife died 26 November 1966 aged 93.
- 333 George HAYWARD died 5 August 1953 aged 67,
Also Emily his wife died 29 February 1956 aged 75.
- 334 Emily HALL died 11 October 1953 aged 75,
Also Sarah Ann BLAKEMORE died 1 December 1959 aged 70.
- 335 Annie Mabel EWELL died 2 December 1953 aged 67,
Also Jack her husband died 30 October 1955 aged 75.
- 336 James DALE died 1 January 1954 aged 83,
Also Sarah Jane his wife of Newham, Yockelton died 2 September 1959
aged 82,
Also their daughter Maijorie Ruth JACKMAN died 9 October 1955 aged 47.
- 337 Frank HAMMOND died 9 February 1954 aged 71,
Also Jane his wife died 29 October 1964 (no age given)
- 338 Elizabeth Frances MASSEY died 8 March 1954 aged 72,
Also James Lambert her husband died 17 October 1957 aged 79.
- 339 John Herbert JONES died 10 April 1954 aged 67,
Also Emily Jane his wife died 20 April 1957 aged 62.
- 340 Martha MORGAN mother, died 28 November 1957 aged 75.
- 341 Martha Jane PURSLOW died 13 September 1954 aged 71,
Also Harry her husband died 11 August 1964 aged 84.
- 342 Jessie O'dell NORRIS died 7 March 1955 aged 53.
- 343 Arthur Roylance CHURTON died 24 August 1954 aged 36.
- 344 Walter JONES died 19 June 1954 aged 58,
Also Martha JONES died 14 March 1966 aged 72.
- 345 Dennis Edward ELLIS died 30 April 1954 aged 23. 346 Charles OVERTON
died 7 February 1954 aged 64,
Also Margaret his wife died 27 October 1972 aged 88.
- 347 Dorothy Mary PURSLOW mother, 1917-1984

- 348 Gertrude Kate (Kitty) wife of Hugh Paterson STEWART died 27 June 1955
(no age) 3
- 49 Harry OVERTON - vase only, no other details.
- 350 Sarah Ann ECCLESTON died 6 March 1957 aged 64,
Also Charles F her husband died 13 January 1959 aged 74.
- 351 Minnie E LEWIS 1895 - 1956
- 352 Elizabeth ann CROFT died 14 August 1956 (no age given)
- 353 William Richard HILL died 23 October 1955 aged 56. 354 Frederick Wm
DAVIES died 21 April 1955 aged 56,
Also Elizabeth his wife died 28 January 1975 aged 77.
- 355 Mary Jane NEWNES died 9 March 1955,
Also Thomas NEWNES died 2 June 1965 (no age given)
- 356 Sarah Maria PHILPOT died 22 June 1956 aged 72,
Also Charles James her husband died 31 August 1969 aged 83.
- 357 John PUGH died 4 April 1957 aged 74,
Also Jessie May died 17 December 1982 aged 74, Late of Parkfields.
- 358 Samuel EVANS died 8 November 1957 aged 64,
Also Ann his wife died 22 December 1981 aged 89.
- 359 Mary Ann PHILLIPS died 1 July 1959 aged 79,
Also William her husband died 17 December 1966 aged 83.
- 360 Rose Kathleen PUGH died 5 August 1957 aged 41.
- 361 Moses COOPER died 4 October 1957 aged 75,
Also Nellie his wife died 27 October 1963 aged 75.
- 362 Emma NASH died 30 December 1959 aged 84,
Also Arthur Henry her son died 6 May 1969 aged 64.
- 363 William (Bill) WHETTALL husband, died 30 May 1962 aged 54.
- 364 George Edwin WHETTELL died 30 May 1962 aged 62,
Also Rosaline Ann his wife died 11 November 1980 aged 77.
- 365 Harold George RUFF husband and father died 26 April 1983 aged 51.
- 366 Anne Martha DAVIES died 11 April 1958 aged 50. 367 Elsie GRIFFITHS
wife, died 21 March 1958,
Also Bertram G GRIFFITHS aged 62 (no other dates of ages)

- 368 John Pryce DAVIES died 27 October 1958 aged 55. 3
- 69 Alfred B HUMPHREYS died 16 December 1959 aged 59,
Also Lilian Anne his wife died 9 June 1984 aged 82.
- 370 Frank DAVIES husband and father died 19 April 1960 aged 46.
- 371 Robert Cecil MANSELL died 19 December 1959 aged 23.
- 372 William TURNER of Pontesford died 14 June 1960 aged 85,
Also Ruth Hannah his wife died 21 May 1978 aged 96.
- 373 Edwin BENNETT died 23 September 1960 aged 65,
Also Kate his wife died 19 November 1963 aged 67.
- 374 Addi RHEECE died 3 January 1961 aged 85,
Also Mary her sister died 29 October 1962 aged 80.
- 375 William Henry TEAGUE died 25 March 1961 aged 73,
Also Mary Ellen his wife died 31 May 1973 aged 86.
- 376 William Bernard ROBERTS died 1 November 1960 aged 81,
Also Elizabeth Ann wife died 8 February 1964 aged 86.
- 377 George H TOMLINS 1890- 1962
- 378 William JONES Late of White Banks died 30 January 1962 aged 79.
- 379 Susie Elizabeth wife of Samuel POWELL died 15 February 1962 aged 52.
- 380 Hannah Maria SPEAKE died 14 April 1962 aged 54,
Also James Albert died 25 March 1980 aged 80, Mother and Father.
- 381 Lily Minnie BIRKETT died 20 May 1962 aged 63.
- 382 Alfred James LINSELL Priest, born 23 September 1889, died 17 June 1962.
- 383 Alfred James DA VIES died 17 August 1962 aged 73,
Also Rosina Gertrude his wife died 26 June 1973 aged 83.
- 384 Alan Robert MADELEY died 16 November 1963 aged 59.
- 385 Margaret Joan POWIS died 19 June 1962 aged 40, Wife and Mother.
- 386 Margaret PORTER died 20 October 1962 aged 58,
Also William Richard her husband died 22 May 1983 aged 72.
- 387 Harriet Rebecca CHALLINOR died 3 November 1962 aged 69,
Also Richard husband died 6 May 1977 aged 83.

- 388 David Alfred TURK died 28 August 1963 aged 77,
Also Gladys his wife died 20 October 1968 aged 78.
- 389 Albert Edward BUNTIN died 9 January 1964 aged 67,
Also Emma his wife died 12 May 1983 aged 85.
- 390 Edwin NICHOLLS (Weeping Cross) died 18 June 1964 aged 84.
- 391 Henry HO WELLS died 25 June 1964 aged 84.
- 392 Joseph MORRELL husband and father died 9 July 1964 aged 43.
- 393 John Richard OAKLEY died 15 April 1964 aged 62,
Also Eleanor Ruth his wife died 30 April 1983 aged 82.
- 394 Ann EDWARDS died 26 December 1964 aged 76,
Also George her husband died 4 January 1968 aged 76.
- 395 Alfred SMITH husband of Betty died 19 June 1969 aged 55,
Also Elizabeth SMITH died 28 May 1987 aged 67. Mum and Nana.
- 396 Herbert C TROW died 5 July 1969 aged 64,
Also Edith M TROW died 1 November 1973 aged 67. Parents.
- 397 Joan Agnes MAYNE died 26 June 1965 (no ages given)
- 398 Emma Elizabeth LEWIS died 25 August 1965 aged 82,
Also Charles Edward her husband died 31 January 1966 aged 80.
- 399 Rosamind Kitty DA VIES 1908 - 1966,
Also Edward her husband 1906 - 1983
- 400 Charles Edward GILES died 18 October 1965 aged 76,
Also Alice his wife died 30 August 1968 aged 84.
- 401 Clarence KINSEY died 18 November 1965 aged 55,
Also Clara Lorna his wife died 24 December 1980 aged 61.
- 402 Richard Clifford LEWIS Bank House died 6 January 1979 aged 59 Father
and Grandfather.
- 403 Cyril Malcolm LEWIS 'Eaton Rise' Pentre died 5 January 1976 aged 60
Husband, Father and Grandfather.
- 404 Gladys Winifred JONES died 18 December 1969 aged 56,
Also George Victor her husband died 21 March 1976 aged 74.
- 405 Simon Dennis LEWIS died 1 July 1968 aged 45 Husband and Father.

- 406 George Leslie SPICER died 13 May 1968 aged 64. 407 Edith BROWN daughter of John BROWN Russell Hall. Whitby, 1882-1968
- 408 Esther PRICE wife and mother died 23 January 1968 aged 72,
Also William Thomas George PRICE husband and father died 12 February 1971 aged 79.
- 409 Ida Ellen MADELEY died 22 January 1968 aged 80.
- 410 Ethel May EVANS died 4 November 1967 aged 38, Childre Janet and David.
- 411 Albert MANSELL (Bert) died 7 October 1967 aged 39. 412 John Ivor MOUNTFORD died 13 February 1967 aged 44.
- 413 Charles Thomas Andrew SANDLES died 8 September 1966 aged 52.
- 414 Thomas Charles CHALLINOR of Pontesford Hill died 26 December 1906 aged 66.
- 415 George PACE born 14 January 1848, died 12 August 1906,
Also Marth his wife born 12 September 1843, died 17 July 1906,
Also Daisy their daughter died 23 February 1961 aged 81.
- 416 Curbs, no apparent inscription.
- 417 Emma Gertrude elder daughter of the Late C A BULLOCK MA, Vicar of St James's West Hartlepool and Emma HAND AS YD his wife died 9 December 1904 (no age given)
- 418 William HOLYOAKE died 10 May 1914 aged 50,
Also Elizabeth Ann his wife died 20 July 1938 aged 78.
- 419 William husband of Clara DAVIES and son of the late Samuel and Ann DAVIE S of The Nags Head Inn, died 5 February 1907 aged 40. 4
- 20 Elizabeth wife of William STEPHENS of Pontesbury died 25 February 1907 aged 72.
- 421 Richard CHAPMAN of Pontesbury died 8 October 1906 aged 77,
Also Martha Jane his daughter died 9 September 1926 aged 69.
- 422 Abraham GITTINS Quarry Villa, Pontesbury died 29 May 1895 aged 65,
Also Mary Ann his widow died 9 September 1913 aged 87.
- 423 Mary Jane GITTINS died 27 March 1917 aged 39,
Also Abraham Jandrell GITTINS died 25 December 1962 aged 93.
- 424 Edward SAVAGE of Halston died 17 April 1907 aged 41.

- 425 Annie RODERICK born 26 January 1849 died 10 July 1912,
Also Emma RODERICK died 12 August 1936 aged 84.
- 426 Mary Ann BOWERS of Little Halston died 23 September 1907 aged 72,
Also Thomas her husband died 7 January 1915 aged 76.
- 427 Joseph EDWARDS of Pontesford died 12 February 1908 aged 83,
Also Jane his wife died 8 January 1914 aged 86.
- 428 James COXALL died 5 May 1908 aged 36,
Also James COXALL died 16 March 1918 aged 72,
Also Ann COXALL wife and mother of the above, died 30 May 1933 aged 87.
- 429 Priscilla JONES, New House Pontesbury died 12 July 1882 aged 52,
Also Henry her husband died 9 March 1906 aged 82.
- 430 Richard Toller SEDDON Rural Dean and Rector of 1st and 2nd portions of
Pontesbury, died 6 July 1906 aged 63.
- 431 John TITLEY died 1- July 1918 aged 62,
Also Mary Elizabeth his widow died 5 January 1940 aged 84.
- 432 Stephen JONES of Minsterley, late of The Lea, died 15 March 1915 aged
77,
Also Hannah his wife died 18 July 1926 aged 78.
- 433 Sidney H MIDDLE died 12 December 1921 aged 6.
- 434 George MORRIS of Pontesbury died 28 October 1916 aged 82.
- 435 Miss Dorothy EVANS late of Nant-y-Meichiaid, Llanfyllin, died at Fairfield,
Pontesbury 23 December 1918 aged 77.
- 436 John George GRIFFITHS died 31 October 1918 aged 32,
Also Mary Ann his wife died 12 January 1940 aged 56.
- 437 Jane ANDREWS died 10 March 1917,
Also John ANDREWS died 24 April 1924 (no age given)
- 438 John MANNING died 5 December 1917 aged 60,
Also Elizabeth his wife died 17 January 1922 aged 69.
- 439 Mary Beatrice JONES of Pontesbury died 18 December 1916 aged 34,
Also William Price JONES died 17 June 1973 aged 76.

- 440 Thomas HALL Parkfields Pontesbury died 11 August 1911 aged 68,
Also Martha his wife died 10 September 1928 aged 83,
Also Martha Jane HALL their daughter died 15 June 1953 aged 82.
- 441 Charles Adam ARMSTRONG, Mangerton, Lea Cross, died 18 April 1918
aged 66,
Also Sarah Jane his wife died 8 February 1936 aged 75.
- 442 Catherine Priscilla SEDDON died 8 March 1916 (no aged given)
- 443 Louisa Jabez DELBRIDGE, Hawthorne House, Minsterley died 10 February
1921, (no age given)
Also Jabez DELBRIDGE died 18 March 1931 aged 75.
- 444 William NICHOLLS born 22 April 1855 died 13 October 1920,
Also Emma NICHOLLS born 31 January 1856 died 21 February 1945.
- 445 Samuel COLES of Pontesford died 12 December 1919 aged 77. 446
William HARRIS of Fords Heath died 27 March 1922 aged 64,
Also Sarah his wife died 8 August 1941 aged 78.
- 447 Richard BREEZE The Nurseries Pontesford, died 31 October 1921 (no age)
- 448 Emirah BOLVER Le Cross late of Minsterley died 4 October 1921 aged 78,
Also Samuel her husband died 15 December 1928 aged 86.
- 449 Agnes Alice daughter of Charles LEE and Alice WILLNER of Hinton Grange
died 12 September 1921 aged 25,
Also Alice WILLNER died 3 February 1959 aged 90, late of Hinton Grange,
Also Aggn— WILLNER of Gur— Bourough died 26
- 450 145282 Driver F BOWERS (Frank) Royal Field Artillery died 20 August 1921
aged 45,
Also Caroline Lucy his wife died 28 April 1950 aged 76.
- 451 In loving memory of Charles HAYWOOD of Haleshurst Farm who died 16th
August 1924 aged 30 years. It is the Lord let him do what seemeth him
good.
- 452 In loving memory of Stephen EVANS of Pontesford who died March 20th
1924 aged 59 years. At rest.

- 453 In loing memory of Annie Beloved wife of Thomas LATTER who died May 12th 1937 aged 73 years.
Also of Thomas LATTER in his 80th year August 22nd 1942 R.I.P.
Hannah Petrovina LATTER (Pat). Dearly beloved wife of R Nelson WATKINS of c... Ceylon. Deposited in peace July 31st 1923 aged 27 years.
In loving memory of our son Percy LATTER 58th Battalion Canadians, who gav e his lifefor his country October 8th 1916 aged 22 years. Decorated for "Distinguished bravery in the field". "For how can man die nobler than when facing fearful odds, for the ashes of is fathers and the temples of his God".
- 454 In loving memory of Mary, the beloved wife of Richard CORFIELD of Field House Pontesbury died October 6th 1922 aged 82 years. "Peace perfect peace".
Also of the above Richard CORFIELD, ... died March 11th 1929 aged 96 years.
- 455 In loving memory of Annie Elizabeth PUGH of Fishpool, Pontesford who died April 19th 1922 aged 48 years.
Also Benjamin brother of the above died April 19th 1928 — aged 48 years.
The fragrance of their lives remaineth.
In loving memory of Lizzie Marie PUGH sister, Fishpools, Pontesford died January 31st 1949 aged 73 years. "Reunited"
- 456 In affectionate remembrance of Gladys beloved daughter of Adam and Sarah CHALLINOR died July 5th 1927 aged 29 years.
"They shall be mine saith the Lord in that day when I make up my jewels".
- 457 In ever loving memory of our dear mother Martha DRAKE died June 10th 1927 aged 68.
Also of our dear father CharlesDRAKE died Februarynd 1935 aged 76."At rest".Mother and Father.
- 458 In memory of Catherine Mary PEARSON died February 13th 1926 (*no age given*)
- 459 In loving memory of Edwin COLES who fell asleep March 23rd 1930 aged 55 years "Until the day break".
- 460 In loving memory of William, beloved husband of Mary BRICKE of Pontesford who was called to rest June 5th 1929 aged 79 years.
Be ye also ready for in such an hour as ye think not the son of man cometh.
Also Mary his wife died November 15th 1930 aged 82.

- 461 In loving memory of Unis Sheliah COLES who fell asleep June 16th 1929 aged 8 years and 11 months. Parted only till ye come.
- 462 Curbs only, no apparent inscription.
- 463 In loving memory of our dear mother Cornelia Rebecca BREWIN of Pontesbury Hill passed away May 9th 1932 aged 83. Peace perfect peace.
- 464 In loving memory of Richard JONES who died January 20th 1932 aged 66. At rest.
Also of Mary JONES who died April 26th 1953 aged 84 years.
- 465 IN loving memory of Walter C POWELL died October 18th 1931 aged 61 years.
Also of James R POWELL died February 6th 1933 aged 69 years.
- 466 In loving memory of Ellen Elizabeth ALLEN (Nellie) of Sudborough, Northhamptonshire, died July 27th 1931 aged 47. At rest.
- 467 In loving memory of Mary Edyth Marjorie (Molly) JAMESON died May 10th 1928 aged 31 at Buenos Aires whilst nursing on RMS Franconia,
Also Wilfred JAMESON LRCP: LRCS Edin: LFPS Glas: died December 8th 1929 aged 65 years. Therefore be ye also ready. Matt. 24 v 44.
Also 'Edith' wife of Wilfred Jameson who died November 6th 1943 (*no age given*). Rejoicing in hope, patient in tribulation. Romans XII v 12.
- 468 In loving memory of Samuel EVANS died 5th April 1934 aged 71 yrs,
Also of Martha, his beloved wife died February 18th 1953 aged 82 years. "Reunited".
- 469 ?????
Jane SHARP died 17 October 1934 aged 76,
Also John R SHARP died 20 February 1936 aged 76.
- 470 In treasured memory of John, the beloved husband of Laura RICHARDS Pontesbury Hill died May 21st 1935 aged 55 years.
Also the above Laura RICHARDS died July 1st 1937 aged 65 years. Resting where no shadows fall, love and remembrance outlasts all.
- 471 In loving memory of Alfred John STANFIELD died April 2nd 1934 aged 86 years.
Also of Hannah Maria died October 8th 1935 aged 82. At Rest.
- 472 Miriam L COMFORT At rest December 31st 1933 (*no age given*).
- 473 Annie PARKER who departed this life May 3rd 1933 aged 74. Thy will be done.

- 474 In ever loving memory of Annie beloved wife of Edward JONES late of The Grove, Pontesford who fell asleep in Jesus November 12th 1933 aged 69 years. "Safe with Jesus Oh how blest, sweetly in his presence rest, if counted worthy, I shall be re-united there with thee"
Also of Edward JONES died March 28th 1939 aged 79 years "Re-united in Thy presence is fulness of joy".
- 475 PEACE - In loving memory of Elizabeth Annie , the devoted wife of James B. BABER, Highfield who died October 20th 1930 aged 73 years. "In the midst of life we are in death".
Also of James Barnett BABER her husband died November 4th 1939 aged 75 years. "Well done thou good and faithful servant".
- 476 In loving memory of our dear daughter Daisy EVANS who died February 28th 1939 aged 28. "Beautiful memories linger yet of one we loved and cannot forget".
- 477 In loving remembrance of Thomas, the beloved husband of Mary Ann LEWIS died August 21st 1939 aged 66 years "Peace perfect peace".
Also Mary Ann wife of the above died 23rd September 1943 aged 73. "Until the day dawns and we shall meet again".
Also Alick LEWIS 1901 - 1979. "God bless you."
- 478 IHS in loving memory of Irene Daisy Guinevere GROSER died May 8th 1936 (*no age given*). "The souls of the righteous are in the hands of God"
- 479 In loving memory of Elizabeth, wife of Thomas BENNETT died May 8th 1935 aged 67. "Worthy of everlasting life".
Also of the above Thomas BENNETT died March 22nd 1948 aged 76 years. At rest.
- 480 In loving memory of Amram Thomas Isaac COLES who died 18th August 1938 aged 13years.
Also of Florence Elizabeth TANSLEY died 1st November 1963 aged 70 years.

- 481 In loving memory of dear little David beloved son of Godfrey and Kathleen JONES, Edge View, Yockleton died December 21st 1933 aged 1 year and 10 months. Jesus called a little child".
In loving memory of David Evan JONES of Edge Grove died March 17th 1945 aged 83 years,
Also of Emily Mabel beloved wife of the above who died January 21st 1951 aged 75 years. Peace perfect peace.
Also ther son Harold Corbet JONES their son who died February 19th 1980 aged 71 years.
In loving memory of Godfrey David JONES died March 3rd 1985 aged 79 years.
- 482 John Edwin JONES Old Rectory died 28 July 1941 aged 49.
- 483 Thomas James Butler DAVTES died 25 February 1939 aged 47,
Also Margaret Jane died 29 December 1963 aged 71.
- 484 Walter Sidney husband of Elizabeth MANSFIELD died 12 May 1937 aged 68
- 485 Harriett Maud YATES 'Highfield'died 22 December 1952 aged 70,
Also William Baker YATES her husband died 14 March 1934 aged 72,
Also Reginald their son died 6 July 1964 aged 54,
Also Frederick Baker YATES aged 1 year and 5 months interred at Derby January 1909.
- 486 Corbet William CROWTHER died 15 December 1954 aged 81,
Also Sarah Jane his wife died 1 November 1958 aged 79.
- 487 Richard EWBANK, Priest Mated, Rector of Pontesbury 1st and 2nd portions 1923, born 7 November 1865, died 20 February 1936,
Also Mabel Garnett EWBANK died 15 November 1959 aged 99.
- 488 Ernest CARS WELL died 16 August 1939 aged 51.
- 489 Concrete - cannot read inscription.
- 490 James BOWERS died 30 May 1952 aged 84,
Also Martha his wife died 10 April 1962 aged 91.
- 491 Elsie wife of Harold JUKES died 5 September 1958 aged 43.
- 492 William Edward BROMLEY, Plealey died 26 August 1937 aged 69,
Also Emma his wife died 17 June 1960 aged 78.
- 493 Thomas BORE died 7 July 1934 aged 56,
Also Ann Elizabeth his wife died 6 August 1970 aged 91.

- 494 Fanny CORFIELD died 18 November 1932 aged 69,
Also George her husband died 18 October 1936 aged 72,
Also George Robert their son died 28 February 1985 aged 84.
- 495 Mary HOOD died 23 November 1939 aged 48,
Also Ambrose her husband died 31 December 1958 aged 69.
- 496 George William BUNN died 15 April 1940 aged 84,
Also Jane BUNN died 9 August 1952 aged 94.
- 497 James Edward BROMLEY died 10 April 1940 aged 63,
Also Edith his wife died 24 January 1981 aged 94.
- 498 Albert OLIVER, The Post Office, Pontesbury died 7 November 1939 aged 52,
Also Edith May his wife died 13 August 1980 aged 88.
- 499 Cherrie Mary ELCOCK died 3 October 1939 aged 41.
- 500 John BOLDERSTON, Plealey died 17 September 1939 aged 67,
Also Ada his wife died 12 July 1973 aged 98.
- 501 Edward TIPTON The Grange, died 19 August 1951,
Also Mary Ann his wife died 15 July 1955,
Also Daisy their eldest daughter died 27 October 1952,
Also Olive May died 4 March 1983 (no ages given).
- 502 Frederick GRIFFITHS, Brooklands died 31 July 1944 aged 48,
Also Nesta Mabel his wife died 12 November 1976 (no ages given)
- 503 John George YOUNG 'Sunnycroft' died 12 December 1935 aged 69,
Also Frances Mary his wife died 25 June 1961 aged 96,
Also Charlotte Elizabeth their daughter died 4 June 1964 aged 64,
Also John George YOUNG, Farley House died 17 September 1987 aged 83.
- 504 Wallace TITLEY died 18 August 1943 aged 42.
- 505 Roger son of Guy and Freda TURNER, Somerville, Pontesbury died 17 September 1941 aged 7.
- 506 John Corbet son of Henry and Norah HUGHES, Lea Cross died 3 September 1941 aged 7.
- 507 William Edward ROBINSON Radlith died 14 April 1941 aged 70,
Also Lizzie Hannah his wife died 14 March 1947 aged 83.
- 508 Edith BEVAN died 22 February 1941 aged 61,
Also Dan BEVAN died 5 January 1948 aged 66.

- 509 Thomas WILLIAMS, Late of Vessons, died 19 November 1940 aged 85,
Also Emma his wife died 26 June 1942 aged 81.
- 510 John DAVIES died 8 July 1948 aged 70,
Also Jack his son killed in action 18 July 1944 aged 32,
Also Eliza wife of John died 6 December 1954 aged 74.
- 511 Henry JONES, Myrtle House died 2 April 1944 aged 82,
Also Mary Ann his wife died 26 August 1965 aged 99.
- 512 John Edward JONES Mount Farm died 31 October 1940 aged 78,
Also Elizabeth Jane his wife died 4 June 1959 aged 88,
Also Edward Sydney JONES their only son died 30 December 1984 (no age given).
- 513 Lilian CHARLES - EDWARDS born 8 February 1875 died 20 August 1941,
whose husband Lewis CHARLES - EDWARDS MB, ChM, and daughters Lilian
Mary and Lois Marian lie buried at Coventry.
- 514 Edward QUARTERMAIN died 7 August 1942 aged 47,
Also Annie Louise died 19 February 1985 aged 93.
- 515 Amelia Jane TUCKER died 8 January 1942 aged 49.
- 516 John THOMASON Lea Cross died 19 November 1941 aged 81,
Also Mary Ann his wife died 5 December 1943 aged 91.
- 517 Mary THOMASON of Shorthill died 9 September 1946 aged 90,
Also James her husband died 23 January 1952 aged 83.
- 518 Martha Ethel HALL died 26 August 1944 aged 59,
Also Herbert her husband died 20 December 1967 aged 84. 519 John
Alan JONES 1877 - 1948,
Also Margaret Ann his wife 1889 - 1982. 520 Wilfred JONES died 8 May
1941 aged 24.
- 521 Mary REYNOLDS died 6 July 1949 aged 88,
Also George her husband died 23 February 1950 aged 86.
- 522 Alice Mary LOVATT late of Oldbury Wells, Bridgnorth died 22 December
1940 aged 52.
- 523 Norman John HUGHES died 30 August 1942 aged 18,
Also Eileen Sheila HUGHES died 9 February 1947 aged 24.
- 524 Curbs, no inscriptions.
- 525 Curbs, no inscriptions.

- 526 Dorothy Ann HUGHES died 15 May 1949 aged 18.
- 527 Charles PUGH died 5 December 1945 aged 70,
Also Eliza his wife died 19 November 1955 aged 82.
- 528 Thomas John MORGAN, Lower Mill, Pontesford died 22 July 1949 aged 57,
Also Lily MORGAN died 25 October 1970 aged 76.
- 529 Eleanor JONES of Mill Farm died 4 March 1945 aged 73,
Also Herbert her husband died 14 August 1963 aged 86.
- 530 William Harry EVANS died 3 February 1948 aged 31,
Also Harry his father died 16 April 1969 aged 88,
Also Rowena Eveline his wife died 10 January 1975 aged 82.
- 531 Colonel F W CATON - JONES CB, RAMC of Earlsdale died 7 June 1944 aged 83,
Also Alice Pownall FIELDEN (BEE) died 29 August 1964 aged 84,
Also Gwen Ethlin G CHITTY died 2 November 1933 aged 81,
Also Rev. Chas Martin CHITTY her husband, Rector of Hanwood 1898 - 1920 and of Yockelton 1930 - 1937, died 7 January 1938 aged 72,
Also Captain Cecil M FIELDEN, late Kings African Rifles, born 4 May 1888 died 7 December 1949,
Also Francs Eliza CALLANDER died 30 July 1928 aged 96, married 1st Henry JONES of Binnum and Kerratto, South Australia and 2nd Captain George Erskine CALLANDER of Springfield, isle of Wight.
- 532 Alice HUMPHRYS of Pontesford died 27 February 1945 aged 49.
- 533 Wooden cross - no details.
- 534 Mary Hannah PREECE of Pontesbury died 13 February 1951 aged 80.
- 535 Kathleen Annie WILLIAMS died 6 February 1969 aged 74,
Also William Morris WILLIAMS her husband died 25 September 1949 aged 61.
- 536 Thomas Leonard MANSELL died 19 October 1960 aged 70,
Also Sarah Elizabeth MANSELL died 24 October 1952 aged 53.
- 537 Colin and Angelina LOWE no other details.
- 538 Christiana MEDDINS died 19 December 1977 aged 54, Wife and Mother
- 539 Edith TURNER died 7 October 1977 aged 87,
Also Walter TURNER died 14 March 1979 aged 92,
Also R T PIERCE, nephew, died 4 January 1978 aged 49.

- 540 Walter John BUCKETT died 5 May 1959 aged 82,
Also Emily his wife died 5 July 1960 aged 96.
- 541 Florence Mary JONES died 13 March 1957 aged 52,
Also Wallace her husband died 8 September 1971 aged 65.
- 542 Ida Muriel STEADMAN died 10 December 1958 aged 34,
Also John W STEADMAN husband died 17 June 1964 aged 55.
- 543 Edwin (Neddy) CHALLINOR son of Admam and Sarah died 5 September
1959 aged 69.
- 544 Winifred Mary CHALLINOR died 29 July 1962 aged 51.
- 545 Frances Beatrice PUGH died 23 September 1964 aged 60,
Also James her husband died 5 September 1966 aged 58.
- 546 Edna Bessie CHALLINOR died 17 May 1974 aged 70,
Also Adaam (Toby) her husband died 29 June 1977 aged 85.
- 547 John KITSON, The Brades, Pontesbury died 10 October 1978 aged 79.
- 548 Florence May HAMER died 8 July 1978 aged 80,
Also Thomas her husband died 1 March 1983 aged 89.
- 549 Sally MANSELL 1895 - 1978,
Also Percy her husband 1893 - 1986.
- 550 Ethel Maijorie CORFIELD died 30 December 1977 aged 56.
- 551 Lily EDWARDS died 26 December 1977 aged 76,
Also Thomas William (Eddie) her husband died 1 August 1984 aged 81.
- 552 Harry Sheldon BARATT of Minsterley Hall born 11 October 1883, died 6 May
1962,
Also Amelia Rose Adeline (Milly) his wife born 23 January 1893 died 23
November 1976.
- 553 E ASTON vase only.
- 554 Frances Mary JONES died 23 January 1960 aged 67,
Also Charles Henry her husband died 7 March 1965 aged 74.
- 555 George Albert HARRIS died 8 June 1977 aged 76.
- 556 Alfred BENNETT, brother died 30 May 1977 aged 52.
- 557 Arthur Gerald WOODMAN died 27 April 1976 aged 81,
Also Martha Ann his wife died 21 October 1987 aged 84.

- 558 Nellie AGG died 2 February 1976 aged 85.
- 559 Aaron POOLE died 29 December 1975 aged 74.
- 560 Stanley THOM died 21 Novemer 1975 (no age given)
- 561 Frances Elizabeth PHILPOTT died 1 October 1975 aged 66. 562 Mark Andrew JONES died 18 april 1975 aged 3 months.
- 563 John George YOUND died 4 March 1975 aged 73, Janet and David grandchildren.
- 564 Henry BULLOCK, former major in the Royal Canadian Army of Ontario, died at Pontesbury 21 December 1974 aged 76.
- 565 Gwendoline Rose TOMKINS died 7 October 1974 aged 80.
- 566 Albert Allan CHALLINOR died 1 September 1974 aged 72,
Also Kathleen Joyce his wife died 12 November 1967 aged 54.
- 567 William Rowland OVERTON died 12 May 1981 aged 65.
- 568 William Oswald OAKLEY died 15 April 1981 aged 70.
- 569 Elizabeth Mary Jane MANSELL died 7 October 1980 aged 3,
Also Henry Sampson MANSELL died 27 May 1984 aged 8 Remembered by parents and grandparents.
- 570 Agnes Winifred COOPER died 7 May 1980 aged 67.
- 571 William (Jack) PHILLIPS died 8 August 1980 aged 74,
Also Maud his wife died 22 April 1981 aged 76.
- 572 Edward Henry HOWELLS of Plealey died 24 February 1980 aged 63,
husband and father.
- 573 Albert Edward BROMLEY died 21 January 1980 aged 69.
- 574 Thomas Herbert CORFIELD died 12 February 1979 aged 65.
- 575 Eleanor HEPWORTH 17.7.1905 - 5.12.1978,
Also George William her husband 26.3.1906.-22.2.1987.
- 576 Millicent Anne HUNT died 24 October 1984 aged 69.
- 577 Mathew T STEALEY of Pontesbury died 8 December 1983 aged 82,
Also Ethel his wife died 1 February 1987 aged 85.
- 578 Frederick James Blayney THOMAS born 7 November 1899, died 5 April 1982.

- 579 Samuel PUGH died 7 October 1982 aged 57.
- 580 Albert Bryan DA VIES died 31 December 1982 aged 55.
- 581 Ted FRANCE died 15 January 1983 aged 59.
- 582 John George Morris GRIFFITHS died 11 February 1984 aged 67,
Also Barbara Margaret his wife died 8 September 1985 aged 53.
- 583 Kate JONES 19 December 1984 aged 75.
- 584 William ROGERS, Arscott Hall died 9 January 1971 aged 86,
Also Frances Ann his wife died 17 September 1983 aged 96.
- 585 Thomas Richard BROWN died 2 February 1980 aged 65, Brother.
- 586 Samuael THOMAS died 25 January 1980 aged 62, Husband and Father.
- 587 Teddy GRAY died 15 May 1979 aged 67, Husband.
- 588 Lily Frances CHITTY, OBE, MA, SFA of Ingleside, Pontesbury, Shropshire
born 20 March 1893 died 8 February 1979 (daughter of James Charles
Martin CHITTY, sometime incumbent of Hanwood and Yockleton, and of
Ethlin Georgina, nee JONES) Archaeologist and artist.
- 589 Martha Jane MARSHALL dies 3 January 1979 aged 75,
Also Thomas Richard her husband died 25 July 1982 aged 78.
- 590 Cecilia Ann JONES 1959- 1961.
- 591 John Richard PARRY died 2 August 1975 aged 58,
Also Elizabeth Eliza PARRY died 2 August 1975 aged 59.
- 592 Leonard Thomas FRANCE, late of Mytton Dingle died 8 September 1973
aged 59,
Also Ruth his wife died 16 February 1976 aged 69.
- 593 Vida Margaret SHUKER died 18 April 1973 aged 65,
Also John her husband died 27 December 1983 aged 78.
- 594 Constance Alice WORRALL died 30 January 1973 aged 57,
Also James her husband died 25 January 1985 aged 77.
- 595 Harry ANDREWS died 28 January 1973 aged 73,
Also Annie his wife died 21 May 1985 aged 87.
- 596 Cecil (Cyril) REPATH died 19 October 1984. Husband and father.

- 597 Herbert Russell HOLLOW AY husband of Teresa died 24 January 1985 aged 70.
- 598 Albert DAVIES died 19 January 1968 aged 76, aslo Clara Annie his wife died 19 July 1979 aged 86.
- 599 Ethel CLEATON died 22 March 1969 aged 65,
Also William Francis CLEATON died 2 October 1981 aged 74.
- 600 John CHURTON died 3 January 1970 aged 74,
Also Ethel his wife died 6 January 1972 aged 76.
- 601 Alice Christina Helen FELTON died 11 October 1971 aged 61,
Also Henry husband, father and grandfather died 16 May 1988 aged 84.
- 602 Anthony Dennis TUFFIN died 10 April 1972 aged 26.
- 603 John Henry BRADDICK died 26 June 1975 aged 65, Husband and Father.
- 604 Reginald CARSWELL died 20 December 1983 aged 62.
- 605 Sasrah Jane YOUNG died 24 February 1984 (no age given)
- 606 Alice Mabel PURSLOW died 9 August 1965 aged 65,
Also Walter her husband died 26 July 1978 aged 84.
- 607 Miriam (Minnie) WILLIAMS 3.7.1883 - 30.8.1965,
Also William WILLIAMS her brother 11.10.1892- 1.11.1969.
- 608 Mary PRICE died 17 August 1968 aged 70,
Also George Henry her husband died 25 December 1987 aged 87.
- 609 Curbs, no apparent inscription.
- 610 Frances Mary TIPTON, Mother, Brookside Farm, Pontesbury died 7 October 1968 aged 88,
Also William Thomas TIPTON her husband died 9 January 1974 aged 85.
- 611 William abel EVANS died 26 January 1969 aged 73,
Also Mary Ann his wife died 24 September 1977 aged 82.
- 612 Charles William DOWLING died 9 August 1971 aged 76,
Also Elsie Elizabeth wife, mother and nana died 6 August 1983 aged 86.
- 613 Elsie May GILES, wife, mum and nan died 7 September 1983 aged 65,
Also Clement John VICTOR her husband died 13 April 1988 aged 71.
- 614 Joshua Thomas POWELL died 28 November 1965 aged 69,
Also Nellie his wife died 16 November 1978 aged 78.

- 615 Agnes GRIFFITHS died 11 December 1965 aged 78,
Also Henry GRIFFITHS her brother died 27 April 1947 aged 53.
- 616 William Edward WILLNER of Red House, Plealey died 12 March 1966 aged 68,
Also Enid Gwendoline his wife died 1 March 1983 ages 81.
- 617 Stuart Anthony HANNAH died 9 November 1968 aged 3 .1/2
- 618 Elisie GRIFFITHS died 31 December 1969 aged 67,
Also John George her husband died 14 September 1975 aged 79.
- 619 Harry George CROWTHER died 5 August 1971 aged 62, husband and father.
- 620 Winifred Joan BLAKEMORE died 9 December 1972 aged 48, wife and mother.
- 621 Margaret Ellen EVANS died 10 March 1973 aged 79.
- 622 Roland Anthony LAKELIN died 5 April 1970 aged 28.
- 623 James Edgar JONES died 25 December 1970 aged 69, husband and father.
- 624 Albert JOHNSON died 29 December 1970 aged 74,
Also Eunice his wife died 2 December 1976 aged 85.
- 625 Elizabeth Alwyn Doreen HAMPSON died 2 October 1971 aged 52, mother,
Also William Edward her husband died 12 December 1983 aged 70.
- 626 John Edward ELLIS died 27 March 1973 aged 72,
Also Elizabeth Jane his wife died 18 July 1981 aged 80.
- 627 Enid Ellen CHIDLEY died 13 August 1979 aged 33, wife.
- 628 Loe' Yvone KEAYS died 13 April 1985 aged 68, wife and mother.
- 629 Dennis MANSELL died 17 October 1986 aged 63. 630 Desmond Harold LLOYD died 10 June 1985 aged 58.
- 631 Albert Thomas JONES died 6 January 1987 aged 67.
- 632 Kathleen Betty BLUNDELL 1914-1985 6
- 33 Philip James PUGH 13.1.1974 - 4.3.1987 Son and brother.
- 634 Bert ANDRWS 9.2.1923 - 16.6.1986
- 635 Les KYNASTON 9.7.1932 - 2.2.1988 Daughters Wendy and Angela

- 636 Rosalie Alexandra Gladys BROWN 'Bud' born 12 June 1901 died 24 July 1987, Mother, Reunited with Major Darlington BROWN 1898 - 1873.
- 637 Cecil John MANSELL died 26 March 1988 aged 79, husband, father and grandfather.
- 638 Elizabeth Gwendoline EVANS died 7 August 1987 aged 81.
- 639 Stanley WILSON 11.6.1915 - 2.4.1988
- 640 William Henry ROGERS 'Sonny' born 22.May 1918, died 13 September 1987
- 641 Richard Corbet HAMER 4.1.1955 - 2.7.1988
- 642 Richard Bruce NORSWORTHY 25.6.1964 - 28.4.1989 Brother.
- 643 William Dudley JONES (Bill) born 19 June 1907 died 6 January 1988, husband and father.
- 644 Dorothy Elizabeth ROWSON 1907- 1988
- 645 Oliver Edwin Gerald SANDELLS 13 Bailey Crescent, died 13 November 1988 aged 68.
- 646 JohnLatter BARRETT 6.4.1922 - 13.1.1988 647 Sallyann Louise WALTON 9.3.73 - 12.6.88 Sister. 648 Rhea Jane HAYWARD 4.5.73 - 12.6.88
- 649 Katie Jane DENNIS 2.10.72-12.6.88

Stone panels in a brick vertical frame recording cremations

- 650 1985 12 October Ethel TONLEY aged 69
- 651 1986 28 February William EVANS aged 61
- 652 1987 1 January Trevor JONES aged 73
- 653 1987 19 January Jack EVANS aged 65
- 654 1987 11 March Dudley PRICE aged 78
- 655 1987 29 March Jeffrey DAVIES aged 65
- 656 1987 3 August Walter NEWNES aged 70
- 657 1987 22 February Michael OATES aged 61
- 658 1988 2 January Wilfred HAYWARD aged 81
- 659 1988 19 January John NEWTON aged 75
- 660 1988 13 April Percy JONES aged 44
- 661 1988 19 June Mary THOMSON aged 96
- 662 1988 5 July Muriel PERKS aged 90

Inside Church, clockwise from south door

WEST WALL

Framed under glass - Plan probably about 100 years old showing the allocation of pews, as follows:-

Ch.1 T LAWRENCE
Rev. J PHILLIPS, Plealey
Sir H WAKEMAN, Hinton Hall
Rev. H HARRISON
H W MEREDITH Esq, John DAVIES, tenant, farm at Oakes
Mr. THORNES, Edge. Mr BOYER, tenant
St Chad's Farm, Farley, J BRISCOE tenant, J GITTINS Pontesbury
William HEIGHWAY Esq, The Mills
Mr WHITHURST, Oakes Hall, Thos SMOUT tenant
H D WARTER Esq, Oakes, Ricd HOLLIAOK tenant
Mr VAUGHAN, Pontesbury
Mr GARDNER
Thomas HARRIES Esq, Cruckton Hall
Sir H HAWLEY, Coppice House Farm. S HARRIES tenant
Mr PARRY, Hinton, William SMITH tenant
Mr BREEZE, Pontesbury, Rev. J JONES for tenants on Pontesbury Hill
Thomas MADDIX tenant
W H MEREDITH Esq, blacksmith, Lea, — ROBERTS tenant
Mr WILKINSON, Plealey, Thos HARRIES Esq, Arlscot, Henry PHILLIPS
tenant
Mr THORNES, Edge and Mr HEIGHWAY, - EDWARDS Link
BOYCOTT for Moleshurst Cottages, H D WARTER Esq.
Richd WILKES, Plealey, Thos PEMBERTON Esq, Halston
Mr PARRY, Newnham, Mr NICHOLLS
Sir H WAKEMAN for servants to Lea Farm, John BOWEN tenant,
Mr WILLIAMS, Pontesbury, Edward AMES tenant
Rev. J PHILLIPS tenants in Asterley
Mr WHITEHURST Oakes Hall
John REYNOLD tenant Shorthill
Sir H WAKEMAN small tenants at Lea
Thomas HARRIES Esq, J T HOPE Esq, Cruck Farm, Late GOODHALL Tenant
John NICCOLLS Esq, Newham
Sir H WAKEMAN Lea Farm, John BOWEN tenant
Thomas HARRIES Esq for servants Cruckton Hall
H D WARTER Esq Middle House, Cruck Meole, Wm BROMLEY tenant
Thomas HARRIES Esq, Sarscot, Edwd KANDKLES tenant
J T HOPE Esq

Mr WILKINSON Plealey
 H MEREDITH Esq, Lea Cross Inn, Willm HILDSON tenant
 Sir H WAKEMAN Hinton Farm, Ricd HOLLIOAK tenant
 J T HOPE Esq
 Rev. J JONES, B BLOWER tenant Pontesbury shop, J BALDWIN Plealey
 T HARRIES Esq Nox Small Farm, B POWELL tenant
 Rev, H HARRISON
 J WINGFIELD Esq, Onslow Hall
 Thos HARRIES Esq for Ascott House, Coin WHITNEY servant
 The Miss HEIGHWAYS Pontesbury House
 Sir H HAWLEY Bt, Longden Hall, Mr S HARRIES tenant
 Rev. Mr HARRISON, House Pontesbury, Late BRIGHT, Mr HUMPHREYS
 Tenant
 Sir H WAKEMAN Bt, Hinton Hall, Mr T OAKLEY tenant
 Sir H HAWLEY 7 Stars Inn, Mr E THORNES, Mr S HARRIES, Mr T DICKEN
 Mr BOWYER Pontesford, Mr John NICHOLLS Lea
 Mr PRICE Polmere, Widow PRICE tenant
 H MEREDITH Esq, Sibberscott, Wm LLOYD HARLEY tenant
 Mr GARDNER Asterley Farm
 Miss TIPTON Plealey
 Mr J NICHOLLS Newnham, Thos HARRIES Esq, Meole Farm, Mrs ROGERS
 tenant
 Mr GRIFFITHS Edge Farm, John EVERALL tenant
 Mr Thomas GIOTTINS Brook Farm Pontesbury
 Thomas PEMBERTON Esq, New Mills, Richd BEDWARD tenant
 — BERRINGTON Esq Little Hanwood, Mr J A EFFSON tenant
 — BERRINGTON Esq Panson and Moat Hall, Mr CLARKE and tenants
 Sexton
 H D WARTER Esq Cruck Meole Upper House, —SPARROW tenant
 Thomas HARRIES Esq Cruckton Hall
 Mr FRANCE Plealey, H D WARTER Esq, Oake, James CORFIELD tenant
 Thos HARRIES Esq, Arlscott Farm, Mr BOOTHBY and Mrs GITTINS tents
 William HEIGHWAY Esq Pool Place and Hill Farm, Samuel BRAZENOR
 Farley
 Sir H HAWLEY Hinton Farm, John SIMMONS tenant
 Mr WATTON Longden, Mr BLACK tenant, Mr BITTON Mr GLOVER tenant
 H D WATERS Esq Cruck Meole House
 Thomas HARRIES Esq, Holly Bank. William CROSS tenant
 Mr WILKINSON Plealey
 Rev J PHILLIPS Plealey, George PEACOCK tenant
 Mr HUSKETT Longden, Thomas HARRIES Esq, Sarscott, John LLOYD tenant
 Humphrey PARRY Esq Hinton
 Mr R LLOYD Nox

J HOPE Esq Nills Farm , J RODERICK Pontesbury, Mr ROGERS tenant
J Thos HOPE Esq tenants in Pontesbury, lease to W HUMPHREYS.
GARRET and BARLOW tenants
Home of R WILKES Plealey
Thos PEMBERTON Esq, Great Halston or Aurion, Mrs Ann OAKLEY tenant
Mr O OWEN Malehurst
Mr O OWEN Malehurst
Mr GRIFFITHS Edge, J EVERALL tenant
Wm HEIGHWAY Esq, Lower House Pontesford
Miss TIPTON Plealey
Mr J PHILLIPS Plealey, John LUCAS tenant
Mr J PHILLIPS, Mr HUSKETH Longden
Miss TIPTON Plealey Farm

- Ch.2 Wooden board - In memory of Frances PUGH mother of William PUGH curate of this church many years, was interred near this wall 23 January 1744 aged 74, also John son of Frances PUGH was buried 10 December 1771 (no aged given)
- Ch.3 Wooden board - In memory of the Late Rev William PUGH formerly curate of this parish died 18 February 1775 aged 74.

INSIDE CHURCH, NORTH WALL.

- Ch.4 Wooden board - The Collegiate church of St George, Pontesbury was built in 1250 on the site of an old Saxon minster. It was taken down in 1825 and rebuilt on the old foundations at a cost of £5000, including £200 from the Church Building Society, and £200 from Mickel Foundation of the Queen's College, Oxford, the ancient chancel alone remaining intact. The body of the Church was restored in 1897 at a cost of £600. The Chancel was restored in 1904 at a cost of £600 by the Rectors W F Lighfoot HARRISON Incumbent of the David Canonry or Prebend S J ABBOT-HAWKES Incumbent of the Childe's Hall Canonry or Prebend E Mainwaring FURLEY Incumbent of the Col Hall Canonry or Prebend
- Ch.5 Marble tablet - Mary HEIGHWAY of Pontesford born 2 March 1787 died 6 May 1849, also Elizabeth HEIGHWAY of Pontesford born 22 October 1785 died 16 June 1867, daughters of William and Jane HEIGHWAY. This tablet erected by their nieces Frances, Catherine and Eliza-Mary JONES.
- Ch.6 Marble tablet - John OLIVER of Shrewsbury, Esq, died 24 November 1789 aged 48, also Bold OLIVER of the same place, Esq, died 8 May 1891 * aged 44, also John and Spencer BOLD sons of Bold OLIVER Esq. John died 18 October 1788 aged 4, Spencer BOLD died 3 September 1797 aged 9, also Elizabeth OLIVER widow of Bold OLIVER Esq, died 7 May 1801 aged 54. (* this date appears wrong possibly 1791?)

EAST WALL, CHOIRSTALLS and CHANCEL

- Ch.7 Marble tablet - Jopn PHILLIPS Esq of Plealey died 27 April 1801 aged 45, also Elizabeth his daughter who died an infant, Mrs Elizabeth PHILLIPS caused this monument to be erected in memory of her husband.
- Ch.8 Stained Glass Window - Mary Edythe Marjory JAMESON died 10 May 1928 aged 31. This window is given by passengers on R.M.S. 'Franconia'

- Ch.9 Stone tablet - Robert PHILLIPS of Cruck Meole Esq, died 18 April 1772 aged 96, also Catherine his wife and daughter of Sir Edward ACTON of Aldenham, Bart, died 14 October 1743 aged 58. They had issue Edward and Mary. Edward died young. Mary married Thomas HARRIES of Cruckton Esq. died 23 January 1767 aged 48, also Thomas HARRIES died 27 September 1798 aged 82.
- Ch.10 Marble tablet - Robert PHILLIPS of Meol, Gent, died 2 June 1679 aged 46, also Mary his wife and daughter of Thomas OWEN of Whitley, Esq. died 24 July 1710 aged 71, they had issue 5 sons and 4 daughters Robert who died an infant, Ann, Mary, William, Edward Owen, Jane, Robert and Martha.
- Ch.11 Marble tablet - Frances PUGH died 23 January 1744 aged 74, also John her son died 10 December 1771 (no age given), also William PUGH curate of this parish died 18 February 1775 aged 74.
- Ch.12 Stained Glass Window - In memory of Heighway JONES of Earlsdale in this parish born 9 August 1818 died 6 May 1876, also Mary his wife born 2 March 1811 died 11 September 189-.
- Ch.13 Marble tablet - Beatrice Margaret GRIFFITH born 15 September 1779 died 1 May 1860, relict of William GRIFFITH, Esquire of Claremont Hill, Shrewsbury, daughter and last surviving and sole representative of Francis TIPTON Esq of Plealey House and also of Bourton in this county, by Anne Catherina his wife who was daughter of Henry WATER Esq of Cruck Meole.
- Ch.14 Stained Glass Window - In memory of Alice Emily FURLEY born 19 August 1848 died 1895.
- Ch.15 Bronze plate - the inscription is in Latin but the essential details appear to be Owen DAVIS died 1614 aged 72, also Mary his wife daughter of Richard FORESTER

died 1596.

- Ch.16 Stone tablet - This inscription is in Latin but the essential details appear to be Thomas DAVIES died 13 September 1574 aged 61.
- Ch.17 Wooden cupboard - Doors engraved HP, HH, WR 1652
- Ch.18 Stained Glass Window - SH 16.9.1788 - 20.2.1859 AH 1.2.1796 - 19.5.1882
- Ch.19 Marble tablet - Richard Ward OFFLEY of Hinton Esq, died 29 May 1762. Gentleman of ancient family, he marries Sarah daughter of George PEMBURY of Wotherton Esq, by whom he left issue a daughter Sarah and one son Ward OFFLEY who died 24 November 1793 aged 32 at Antigua whilst in the service of his country.
- Ch.20 Marble tablet - Joannes MacGILVRAY A.M. born 1751 died 1823 the whole of his inscription is in Latin.
- Ch.21 East Window - This Chancel consecrated by CANTELUPE under Edward 1 AD1280 was re - dedicated by Bishop PERCIVAL under Edward VI AD 1904
- Ch.22 Marble tablet - Harriett wife of Dr Leslie HONBLE E I Co's Bombay Estabt, and youngest daughter of the late Wm HEIGHWAY Esq, Pontesford, died off the coast of Africa 28 March 1824 on her passage to England from Bombay on board Aurora Indiaman.
- Ch.23 Bronze plate - William HARRISON Rector and Patron Pontesbury 1st portion for 54 years 1847 - 1901.
- Ch.24 Stained Glass Window - In memory of the Revd. Hamlet HARRISON BD, rector of 1st portion of this parish died 2.0cotber 1843.
- Ch.25 Marble tablet - William HEIGHWAY died 14 February 1749 aged 64, also Mary his wife died 14 June 1760 aged 65, also Samuel their eldest son died 9 December 1784, also Elizabeth his wife died 27 May 1811 aged 84, also William eldest son of Samuel and Elizabeth HEIGHWAY died 26 October 1809 aged 69, also Jane his wife died 1 May 1820 aged 71.
- Ch.26 Ornamental marble tablet - Rev Henry BALDWYN AM, Rector died 17 July 1737 aged 56, 1st and 3rd portions.
- Ch.27 Stained Glass window - William HARRISON - Latin.
- Ch.28 Marble Tablet - William BOYCOTT of Boycott Esq, died 9 August 1707 aged 46, erected by his widow.

Ch.29 Marble tablet - John PARRY late of Hinton died 5 February 1813 aged 63.

1914 -1918

E	ANDREWS
W	ATHERTON
OW	BROWN
WH	CHALLINOR
J	COOPER
JS	DAVIE S
J	EDWARDS
AN	GILES
Joseph	GWILT
J	HARRIS
J	HOWELLS
CO	JONES
JR	JONES
WP	JONES
GB	MADDOCKS
R	MADELEY
J	PALMER
WA	PRICE
AJ	STANDFIELD
WR	TIPTON
GC	VAUGHAN
JR	WILD
H	ARCHER
A	BAYLEY
E	BROXTON
TD	CLARK
D	CUMMINGS
WE	DAVTES
TH	FORTUNE
JH	GREEN
TP	GWILT
E	HAYWARD
JG	HUMPHRIES
G	JONES
TL	JONES
J	LANGSLOW
GW	MADDOCKS
HR	MANNING

JE	PARRY
J	PUGH
SG	SMITH
CC	TITLEY
E	WEAVER
S J	WILLIAMS
WC	ATHERTON
WC	BREEZE
ER	CHALLINOR
RC	CONNOR
AB	DAVTES
WJ	DUCKETT
H	FURLEY
Jesse	GWILT
JH	HALLOWS
JH	HORDLEY
CH	JONES
H	JONES
W	JONES
R	LEWIS
W	MADDOCKS
AC	MOYLE
HE	PINCHES
W	SANKEY
T	TAMS
GH	TITLEY
W	WHITTALL

1939- 1945

G	CHALLINOR	Ch.34	Brass plate - on back of last
J	FRANCE		pew - In memory of Trevor
D V	MARSHALL		JONES, Churchwarden 1954 -
E W	PURSLOW		1987.
W D	CHALLINOR		
LW	HYDE		
C H	NIBLETT	Ch.35	Printed list framed under glass
G C	STAFFORD		- Rectors of Prebends of 1st
J H	FIELDEN		portion (David)
W A	LLOYD		REGINALD early 13 th century
R C	OAKLEY		1277 DAVID son of Reginald
J H	WILLIAMS		1300 WILLIAM de MONCKTEL
Ch.31	Marble tablet - John NICHOLLS ofNewnham died 9 September 1809 aged 56, also Anne his widow died 26 May 1846 aged 79. SOUTH WALL.		1307 PHILIP ap HOWEL
			1352 WILLIAM de CHERLETON
			1356 JOHN de SCHEYNTON
			1359 GRIFFIN de CHERLETON
Ch.32	Brass plate - Mary and Wilfred JAMESON 10 May 1928. 8 December 1929. Presented by Edith and Mona JAMESON and Doris TUTHILL.		1371 HUMFREY de CHERLETON
			1394 NICHOLAS BRYDEPORT
			1394 Walter PRYDE
			1394 Thomas NEWPORT
Ch.33	Marble tablet - Heighway JONES of Earlsdale in this parish who died as the result of an accident 6 May 1876 aged 57, also Mary his wife born 2 March 1811 died 9 September 1890, also Heighway their son born 9 December 1841 died 20 July 1915, also his sister Mary Jane HEIGHWAY died 21 February 1927 aged 76.		1413 John CARPENTER
			1417 Thomas BRADSCHAME
			1446 Thomas MASSEY
			1464 William KETLEY
			1464 Richard SALTER LL.B.
			1519 John COLE
			1535 John PRYCE
			1575 Roger NORMECOT
			1587 Humfrey CHERWELLB.A.

- 1591 Richard FORSTER M.A.
Owen DAVIE S
- 1596 Moses POWELL M.A.
- 1603 Thomas HIGGONS D.D.
- 1614 Francis GIBBONS D.D.
- 1641 William OWEN M.A.
- 1648 Lawrence LONDON (?)
Timothy HAMMOND B.A.
- 1671 Gilbert COLE
- 1710 Henry BALDWYN M.A.
- 1767 Benjamin WINGFIELD M.A.
- 1763 Osborne WIGHT
- 1800 Joseph LANDFORD B.A.
- 1809 Hamlet HARRISON B.D.
- 1843 John Richard TETLOW M.A.
- 1847 William HARRISON M.A.
- 1901 William Francis LighfootHARRISON M.A.

Ch.36. Printed list, framed under glass - Rectors or Prebends of 2nd Portion
(Nicholas or Childs' Hall portion)

- 1277 WALTER
- 1306 NICHOLAS
WILLIAM de ASTON
WILLIAM de RODE
- 1321 WILLIAM de ASTON
GRIFFIN de CHARLETON
- 1345 JOHN de SCHEYNTON
HUMPHREY de CHARLETON
- 1371 GRIFFIN de CHARLETON
- 1384 John Son of Thomas GECH
- 1387 Howell, Son of David HOLBEECH
- 1417 Hugh
- 1417 John CARPENTER
- 1442 William LONDON
- 1451 William DUDDELEY
- 1476 Thomas BARBOR
- 1490 John HERVEY
William GREY
- 1522 Thomas SHYLLEY
- 1529 William GWYN
- 1540 Richard WYCHERLEY
- 1596 Owen DA VIES M.A.
- 1614 Thomas HIGGONS

Pontesbury Churchyard
Shropshire

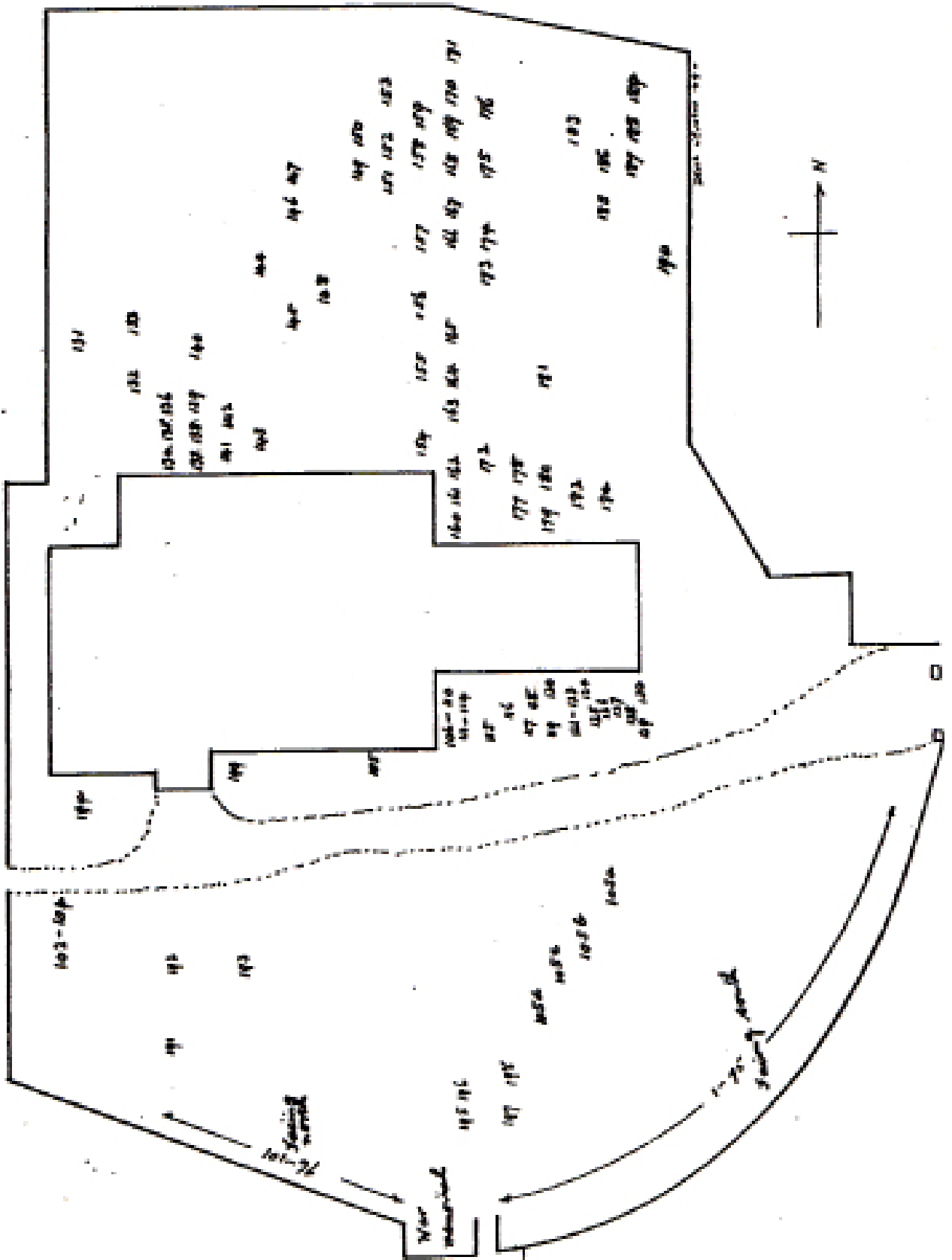

Church Cemetery
 Linley Road, Pontesbury
 Shropshire

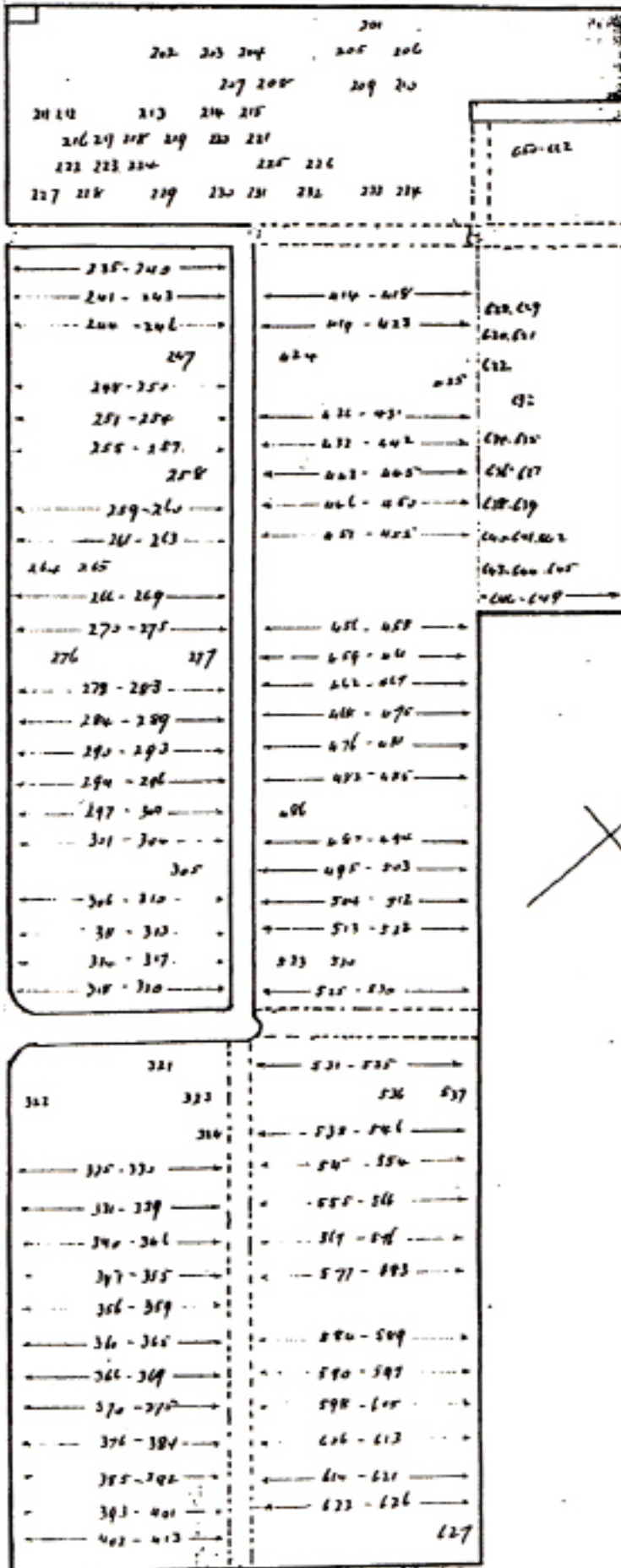

1636 Peter STUDLEY M.A.
 Timothy HAMMOND B.A.
 Coret OWEN
 William OWEN
 1672 William OWEN M.A.
 1726 William DALE B.A.
 or
 1739
 1764 Charles NEWLING
 1770 Edward LEIGHTON B.A.
 1803 Charles PETERS M.A.
 1824 Charles DRURY M.A.
 1868 Samuel John HAWKES M.A.
 1909 1 st and 2nd Portions united

Ch.37. Printed list, framed under glass - Rectors or Prebends of 3rd Portion. (Ratford or Cold Hall portion)

1278 THOMAS de WYNTON
 1292 ROBERT de RATFORD
 1315 THOMAS de CHARLETON
 LEWIS de CHARLETON
 WILLIAM de ASTON
 1359 HUMPHREY de CHARLETON
 JOHN de RODENE
 1395 John GOUMEN
 1397 Richard HUSSEY
 1401 William, son of John BURLE Y
 1413 William CORVE
 1417 David ap THOMAS
 Lawrence ROCHE
 1453 John GOMOND
 1471 Thomas DANET
 Thomas JENYNS
 1519 William TOSTE
 1521 John FYSSHER
 1532 Ludovic BAKER
 1535 Michael BROMSTALL
 1576 Edmund TIPTON
 Lancelot LAKE
 1627 Samuel GREAVES M.A.
 Andrew WATER
 1660 Timothy HAMMOND B.A.

Ralph MURRALL
1681 Ralph HARPER B.A.
1707 Henry BALDWYN M.A.
David PRICHARD
1795 Forester LEIGHTON B.A.
1813 John WILDE
1827 William VAUGHAN M.A.
1867 Lionel CORBETT M.A.
1873 Algenon Godfrey KINGSFORD
1882 Edward Mainwaring FURLEY M.A.
1914 Ferderinck Tusting MILLWARD M.A.
1938 Gerald Edward Miles GARDNER-BROWN M.A.

Ch.38 Printed list, framed under glass - Rectors 1st and 2nd Portions

1909 Richard Toller SEDDON
1917 William Herbert SEDDON M.A.
1922 Richard EUBANK M.A.
1931 Gilbert Salkeld STOCKLEY M.A.
1944 Ralph CLAYTON M.A.
1958 Robert Cyril WESTALL M.A.
1966 Alfred William WEBSTER - SMITH M.A.
1976 David Henry ROBERTS B.A.

WAR MEMORIAL 1914-1918

Wm.1	Brig. Gen. Goring JONES CMG, DSO
Wm.2	Cap. Derwas CUMMING MC
Wm.3	Lieut. W ATHERTON MC
Wm.4	Lieut. J C HALLOWES
Wm.5	Q.M. Sergt. J R JONES
Wm.6	Sergt. G B MADDOX
Wm.7	Sergt. F STANTON
Wm.8	L. Sergt. H R MANNING
Wm.9	Corpl. RC CONNOR
Wm.10	Corpl. Hugh FURLEY
Wm.11	L. Corpl. T H FORTUNE
WM.12	L, Corpl. C L TITLEY
Wm.13	L. Corpl. L WHITTALL
Wm.14	Pte. F ANDREWS
WM.15	Pte. H ARCHER
Wm.16	Spr. C W ATHERTON
WM.17	Pte. W C BREEZE
Wm.18	Pte. O W BROWN
Wm.19	Pte. A BAYLEY
Wm.20	Pte. E BROXTON
Wrn.21	Pte. E R CHALLINOR
Wm.22	Pte. W H CHALLINOR
Wm.23	Pte. T D CLARKE
Wm.24	Pte. J COOPER
Wm.25	Pte. J S DA VIES
Wm.26	Pte. A B DAVIES
Wm.27	Pte. W E DAVIES
Wm.28	Pte. W J DUCKETT
Wm.29	Pte. J EDWARDS
Wm.30	Gnr. Joseph GWILT
Wm.31	Pte. Jesse GWILT
Wm.32	Pte. T P GWILT
Wm.33	Gnr. A N GILES
Wm.34	Pte. J H GREEN
Wm.35	Gnr. J HARRIS
Wm.36	Pte. E HAYWARD
Wm.37	Pte. J H HORDLEY
Wm.38	Pte. J HOWELLS
Wm.39	Gnr. JC HUMPHREYS
Wm.40	Pte. C H JONES
Wm.41	Pte. C O JONES
Wm.42	Pte. H JONES

Wm.43	Pte. T L JONES
Wm.44	Pte. W B JONES
Wm.45	Pte. W JONES
Wm.46	Pte. J LANGSLOW
Wm.47	Pte. R LEWIS
Wm.48	Pte. W MADDOX
Wm.49	Pte. C W MADDOX
Wm.50	Pte. A C MOYLE
Wm.51	Pte. R MADELEY
Wm.52	Pte. J PALMER
Wm.53	Pte. J E PARRY
Wm.54	Pte. H E PINCHES
Wm.55	Pte. J PUGH
Wm.56	Gnr. W A PRICE
Wm.57	Pte. W SANKEY
Wm.58	Pte. S G SMITH
Wm.59	Pte. A J STANDFIELD
Wm.60	Pte. T TAMS
Wm.61	Gnr. W R TIPTON
Wm.62	Gnr. G H TITLEY
Wm.63	Pte. G C VAUGHAN
Wm.64	Pte. E WEAVER
Wm.65	Pte. J K WILDE
Wm.66	Pte. W WHITALL
Wm.67	Pte. S J WILLIAMS

WAR MEMORIAL 1939- 1945

Wm.68	Lieut. J N FIELDEN
Wm.69	Sergt. G CHALLINOR
Wm.70	Sergt. J FRANCE
Wm.71	Corpl. W A LLOYD
Wm.72	Pte. W D CHALLINOR
Wm.73	Pte. DV MARSHALL
Wm.74	W.O. GC STAFFORD DFM
Wm.75	Pte. C H NIBLETT
Wm.76	Sapr. L W HYDE
Wm.77	Stkr. RC OAKLEY
Wm.78	Pte. W E PURSLOW
Wm.79	Gnr. J H WILLIAM